



KNAUF SHEETROCK® FIRESTOP™

Fire-Resistant, Industry Leader

Knauf Sheetrock® Firestop™ is specially developed and tested for use in fire rated applications. Knauf Sheetrock® Firestop™ is ideal for walls and ceilings in residential and commercial constructions for fire protection. The application of Knauf Sheetrock® Firestop in single and multiple layers provides a variety of fire rated and acoustic performance.

KNAUF

Build on us.

Advantages



Fire Safety

- Knauf Sheetrock® Firestop™ is able to prevent the spread of fire up to 4 hours, depending on system applied.
- Knauf Sheetrock® Firestop™ is ideal for lining walls and ceilings to ensure effective fire protection.



Aesthetics

- Seamless and smooth finish.



Consistent Quality

- Produced in a state-of-the-art ISO 9001 certified plant.

Product Data

Thickness (mm)	12.5	16.0	Edge Detail Product	Tapered
Nominal Weight (kg/m ²)	11.50	13.60	Standard	BS EN 520
Nominal Density (kg/m ³)	920	850	Product Testing	BS 476 Part 6
Size (mm)	1220mm X 2440mm		System Testing	BS 476 Part 7 BS 476 Part 22

Please refer to Knauf representative for other board sizes.

Applications

Suitable for fire rated partition systems, for commercial and residential buildings.

Systems

Knauf 1-Hour Fire Rated Ceiling System

NOTE:

1. Internal Pressure: $P_{ult} = 0.375 \text{ kPa}$
 $P_{ser} = 0.250 \text{ kPa}$
2. Deflection Limit: $L/360$ with maximum 12mm under service loading for internal ceiling
3. Ceiling system weight 54.4kg/m²

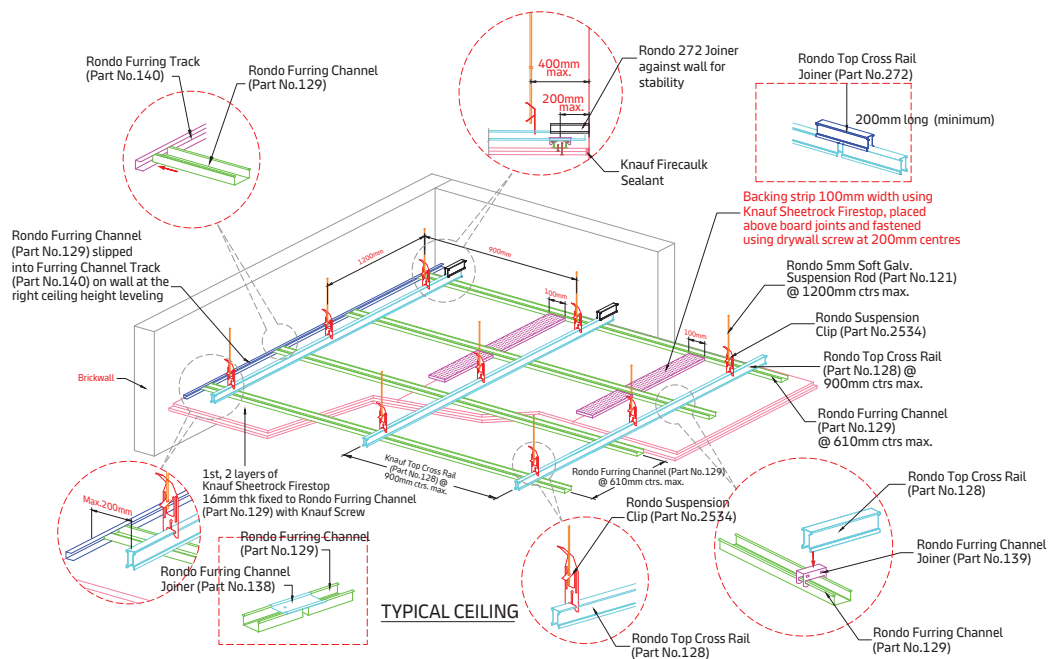

Knauf 1-Hour Fire Rated Drywall System

KNAUF METAL PRODUCTS:

Shall be free from red rust by 50%, in accordance with ASTM D610-08 (2019) - Standard Practice for Evaluating the Degree of Rusting on Painted Steel Surfaces.

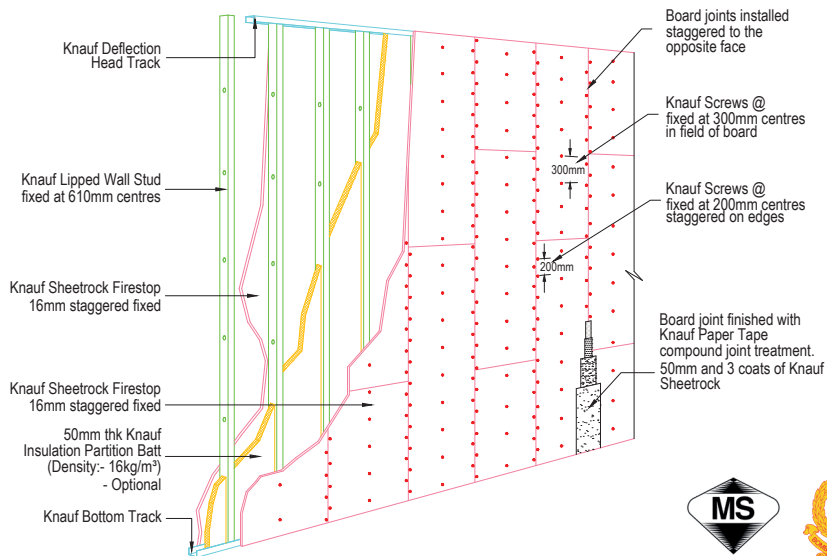

Knauf Sdn. Bhd

Lot 606, Jalan Lagoon Selatan, 47500 Subang Jaya, Selangor, Malaysia
T: (03) 5629 2000 E: contactusmy@knauf.com W: www.knauf.com

© 2024 KNAUF. All rights reserved. KNAUF and FIRESTOP are trademarks of Knauf Sdn. Bhd. or one or more of its affiliates. SHEETROCK is a trademark owned by United States Gypsum Company and used under license. Information provided is for reference purpose only. Due care has been taken to ensure accuracy at time of publication. Products, specifications, and requirements may vary according to geographical locations and applications. As each project is unique, please contact your nearest Knauf representative for further assessment



Scan to visit our website



PB02_FL_0824_V8 P_PB02_0824_01