



AMFIPANEL(B)

- Acoustic wall panel for cinemas
- Installation through pre-bored holes
- Black painted

CONDITIONS OF USE

- For internal fitout of buildings
- To be installed in a closed-off building

STORAGE

The products must be:

- stored indoors clean and dry
- positioned on a level base
- protected from direct moisture
- stored at humidities of less than 70% RH and temperatures of less than 50°C
- protected from impact and shock
- stacked max. 2 pallets on top of each other

Before installation, please ensure that fixtures to primary construction can withstand the load of the ceiling.
Best Practice: Use of clean cotton gloves when handling product tiles will ensure a good result and a ceiling without fingermarks.

RECOMMENDED ACCESSORIES FOR FIXING OF AMFIPANEL

Below accessories are tested and approved for use in connection with Amfipanel.

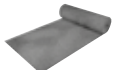
	PRODUCT NAME	SAP NO.	SIZE
Accessories	 SN screw	3503	3.5 x 30
	 Kino acoustic felt	592361	1.26 x 100 mm

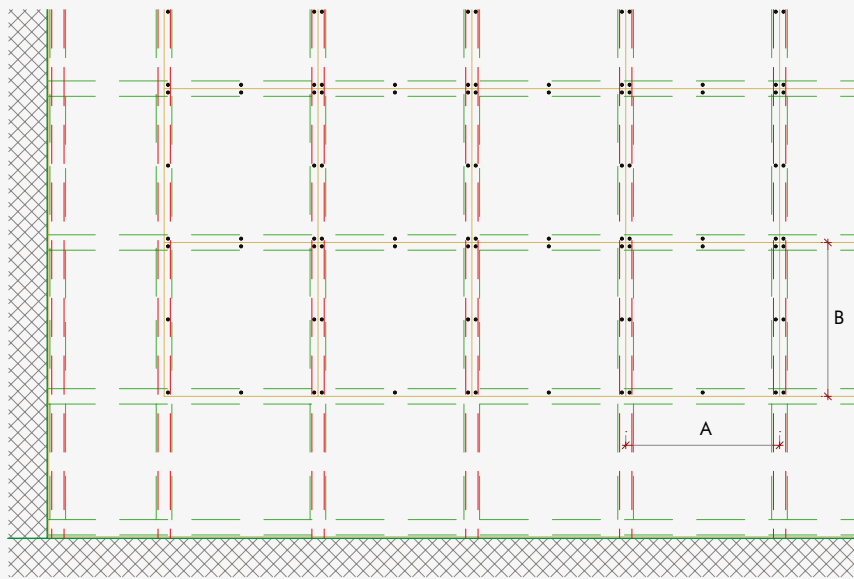

INSTALLATION GUIDE FOR AMFIPANEL

WALL LAYOUT

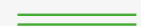
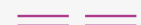

A = Max. 600 mm B = Max. 600 mm

Legend:

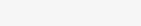
-  22 x 60 mm furring
-  Battens
-  Black Screw SN3.5x30
-  Panel edge

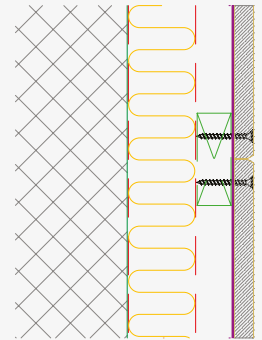

INSTALLATION OF PANELS

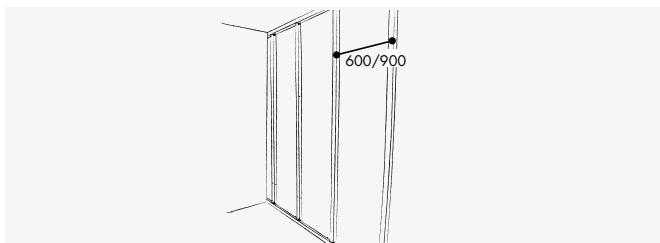

FURRING

- Fix 50x50 mm or 50x100 mm battens vertically at 600 mm (Amfipanel 600) or 900 mm (Amfipanel 900) intervals.
- The battens must be placed vertically precisely in relation to the joint of the panels.

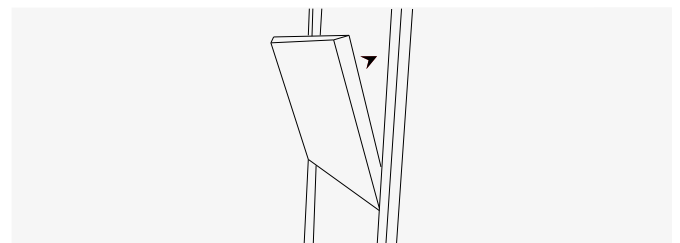

INSULATION

- Place mineral wool (stone wool 30-40 kg/m³ or glass wool 20-25 kg/m³) between the battens.

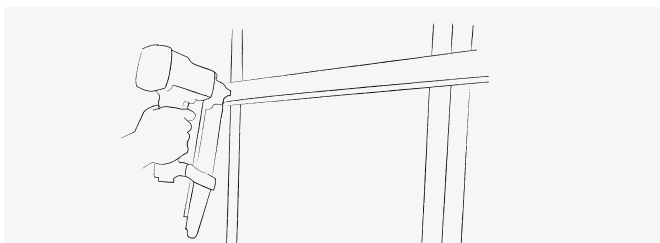

INSTALLATION OF HORIZONTAL FURRING

- Fix 22x60 mm planed battens horizontally to the furring at 600 mm c/c.
- It is important that the battens are mounted precisely and perpendicularly.



INSTALLATION OF VERTICAL FURRING

- Fix 22x60 mm planed battens on top of the primary furring at 600 mm c/c (Amfipanel 600) or 900 mm c/c (Amfipanel 900).
- It is important that the vertical battens are perpendicular to and flush with the horizontal battens, so that the furring structure is completely plane.

INSTALLATION GUIDE FOR AMFIPANEL

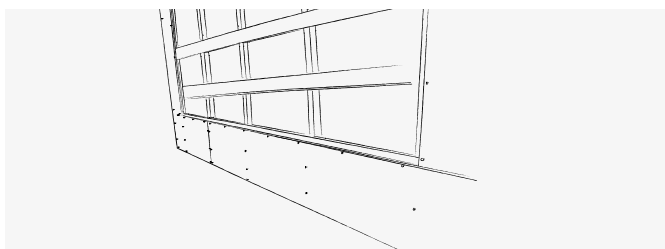

INSTALLATION OF POSSIBLE FRIEZE

- If a frieze is to be installed, it is important that the opening between the friezes is perpendicular and precisely adjusted to the quantity of Amfipanel.
- Install and paint the frieze before installing the panels.

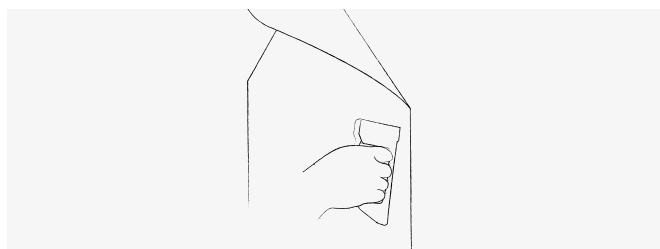

FIXING OF FELT

- Secure the Kino felt to the furring in the area where Amfipanel is to be mounted.

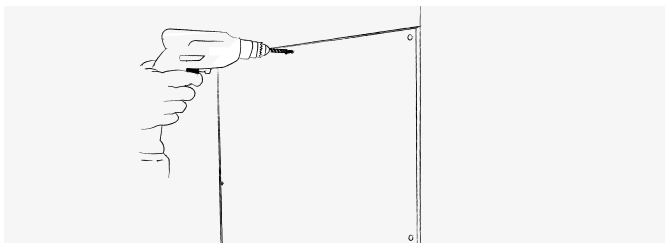

INSTALLATION OF PANELS

- Fix the Amfipanel to the furring through the pre-drilled holes.
- Use black screws (min. 30 mm).