

Note on English translation / Hinweise zur englischen Fassung

This is a translation of the product data sheet valid in Germany.

All stated details and properties are in compliance with the regulations of the German standards and building regulations. They are only applicable for the specified products, system components, application rules, and construction details in connection with the specifications of the respective certificates and approvals.

Knauf Gips KG denies any liability for applications outside of Germany as this requires changes acc. to the respective national standards and building regulations.

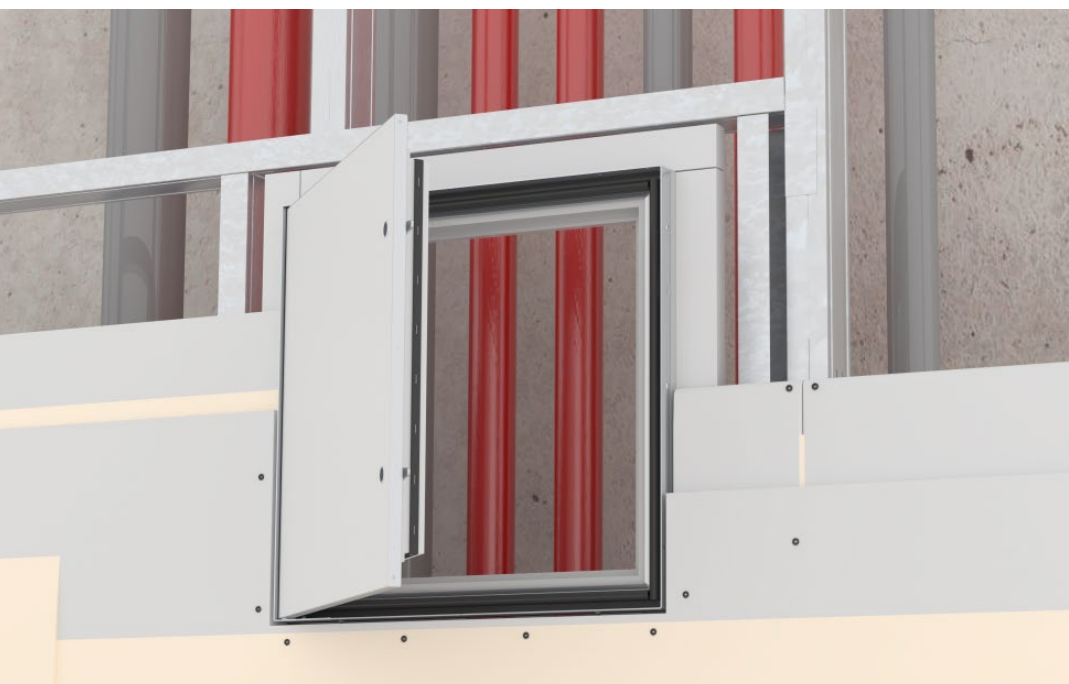

Drywall Systems

E152i.de

Product Data Sheet

2021-11

Access panel seal Installation Shaft Wall I 90

Access panel seal for Knauf Installation Shaft Walls

Product description

The access panel seal installation shaft I 90 consists of:

- Galvanized sheet metal and outer frame
- Factory flush installed GKF inlay
- Seal
- Four square bolt with key
- Enclosed assembly kit
- GKF board strips

Properties and added value

- All-purpose use for cladding thicknesses 30, 40 and 50 mm
- Smoke-proof
- Swivelling hatch
- Precision installation
- Cost-effective application
- Selectable left/right side limit
- Proof of National Technical Approval

Field of application

Installation as an access panel seal acc. to abZ Z-6.55-2183 in fire-proof installation shafts I 90.

System variants

Fire resistance class	Cladding Knauf Piano fire-resistant board	Solid Board	Fireboard	Minimum thickness mm	Use up to application access panel seal Width x length mm	Insulation layer Fire resistance permissible	
						Minimum thickness mm	Min. density kg/m ³
W630.de Installation Shaft Wall					Metal crossbars with CW studs, double-layer cladding		
I 90		•		2x 20	400 x 400	Without or mineral wool G plus	
W628B.de Installation Shaft Wall					Single metal stud frame with CW single studs, double-layer cladding		
I 90		•		2x 20	600 x 600	Without or mineral wool G plus	
		•		2x 25			
			•	2x 20			
W629.de Installation Shaft Wall					Single metal stud frame with CW double studs, double-layer cladding		
I 90		•		2x 20	600 x 600	Without or mineral wool G plus	
		•		2x 25			
			•	2x 20			
W635.de Installation Shaft Wall					Single metal stud frame with UW double runners – double layer cladding + intermediate board layer		
I 90	•			2x 15 + 12.5	600 x 600	Mineral wool S 40 28	

G Mineral wool insulation layer acc. to EN 13162, non-combustible (insulating material, e.g. from Knauf Insulation)

S Mineral wool insulation layer acc. to EN 13162, non-combustible, melting point ≥ 1000 °C acc. to DIN 4102-17 (insulating materials e.g. from Knauf Insulation)

Certificate of Usability

Fire resistance proof

■ abZ Z-6.55-2183

Wall heights up to 4.00 m

The specifications marked with **plus** offer additional application options, which are not directly included in the Proof of Usability. On the basis of our technical assessments, we assume that these marked design solutions can be assessed as a non-significant divergence. On request, we can make the documentation on which this assessment is based, such as experts opinions or technical assessments, available to you together with the Certificate of Usability. We recommend that a non-significant divergence be coordinated and authorised in advance in consultation between the persons responsible for fire resistance and/or the relevant authorities.

<p>plus</p> <p>Note</p>	<p>Installation shaft walls with the fire resistance class “F ...” meet the requirements for installation shafts “I ...” of the same fire resistance class (duration). In this respect, the use of F-classified installation shaft walls acc. to system data sheet W62.de as an I-classified installation shaft wall can be considered as a non-significant divergence. Coordination with the building supervisory authority is recommended due to the differing Certificates of Usability.</p>
---------------------------------------	---

Application

The installation is undertaken during the construction of the installation shaft wall.

Trimmer

Arrange trimmers made of CW studs or UW runners in the grid in accordance with the dimension of the access panel seal. Maintain spacings between cut-out section and trimmer profiles of at least 50 mm and a maximum of 70 mm. The trimmer profiles must be crimped or riveted to the studs or cross bars.

See the design details and the scheme drawings on the following pages.

Cladding

Implement the cut-out in the wall cladding 20 mm higher and 10 mm wider than the external dimensions of the access panel seal. Screw fasten the partition cladding to the trimmer profiles as well.

Design (continued)

Installation of the access panel seal

Cladding	
2x 15 mm	<p>25 mm board strip GKF ¹⁾</p> <p>Outer frame</p> <p>Hatch</p>
2x 20 mm	<p>25 mm board strip GKF ¹⁾</p> <p>Outer frame</p> <p>Hatch</p>
2x 25 mm	<p>25 mm board strip GKF ¹⁾</p> <p>Outer frame</p> <p>Hatch</p>

1) GKF board strips are included in the packaging.

Carefully lift the hinge metal of the access panel seal outer frame with a screwdriver and unhinge the latch. Use the access panel seal outer frame with installation aids in the area of the screw holes and insert into opening, align the frame laterally along the installation aids and fix lightly. Check the perpendicular alignment of the outer frame. Screw the aligned and fixed access panel seal outer frame to the side of the wall cladding through all screw holes of the access panel seal outer frame. Firmly fix the access panel seal outer frame with mounting claws and check the perpendicular alignment (squareness) of the frame again.

Always check the perpendicularity and freedom from mechanical stresses of the access panel seal outer frame when screwing it in place.

Screw fastening with Drywall Screws TN 4.3 x 55.

Press the enclosed GKF board strips from the rear laterally onto the access panel seal outer frame and screw through the cladding, $a \leq 220$ mm.

The required screw length depends on the cladding thickness:

- 2x 15 mm / 2x 20 mm: Diamant XTN 3.9 x 55
- 2x 25 mm: Drywall Screw TN 4.5 x 70

Subsequently insert the hatch and check the lock for proper functioning.

Jointing

Fill the joints of the access panel seal outer frame and surface cladding with Unitflott, leaving the hinge area initially free to enable reinserting the hatch. After the filler has set, insert the hatch and fill the hinge area joints. It is not necessary to fill or skim the hatch to surface quality Q2. In case of surface quality level Q3 scrape skim the hatch face. Clean outer frame, hatch, and in particular the seals and intumescent thoroughly after filling.

Notes	Observe the installation instructions enclosed with the product.
	Construct the Knauf systems in accordance with the respective Knauf system data sheets.

Coatings

Surface treatment of the access panel seal with gypsum board inlays in acc. with the system data sheet Knauf Installation Shaft Walls W62.de.

Notes for the painter

Ingress of the paint into the joint should be avoided. Clean any paint remnants from the frame.

Examples, scheme drawings

Vertical grid

Stud spacing a continuous

e.g. Single stud

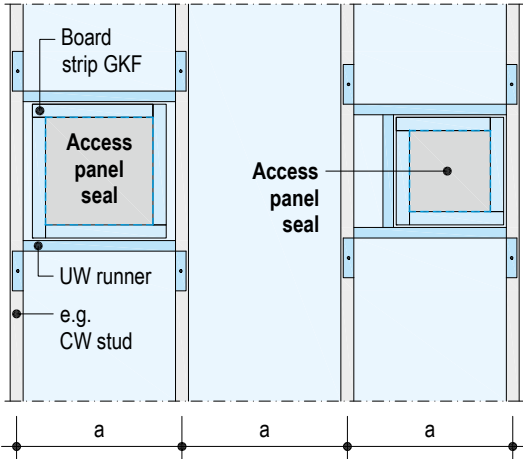

Stud spacing a with cut stud and trimmer profiles

e.g. Double studs

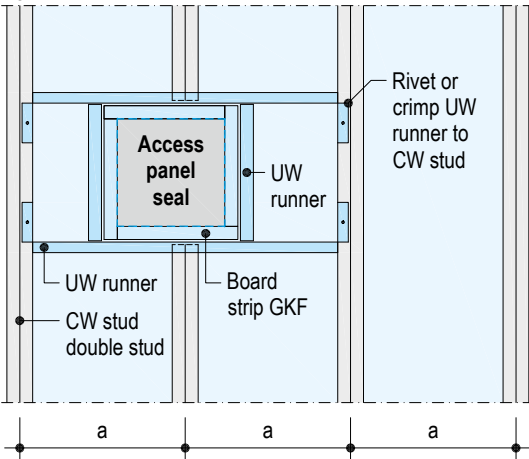

Horizontal grid

Profile spacing a continuous

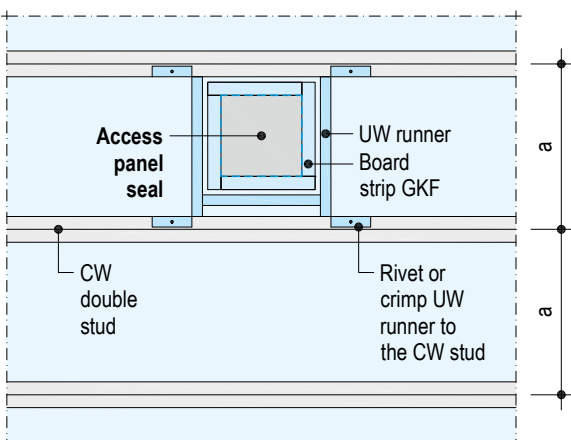

Additional grid

Design details

Scale 1:5 | Dimensions in mm

E152i.de-H1 Installation Shaft Wall I 90 – Horizontal section

e.g. version 2x 20 mm

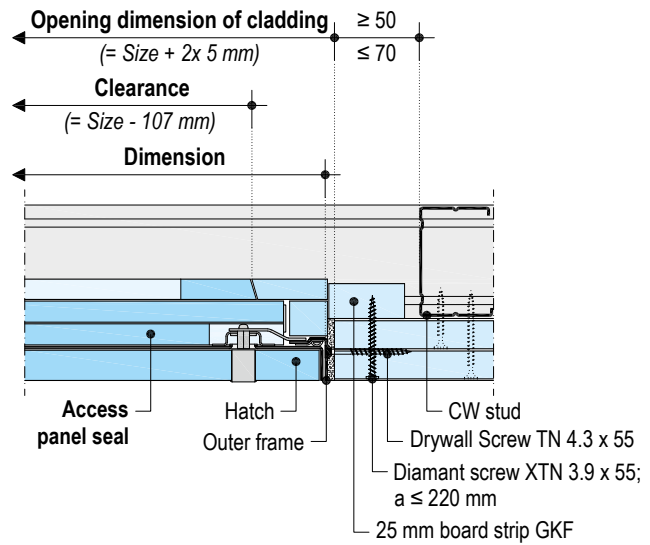

- Implement the cut-out in the wall cladding 20 mm higher and 10 mm wider than the external dimensions of the access panel seal.
- The required screw length depends on the cladding thickness see page 3.

Product range

Description	Application Width x length mm	Outer frame dimensions Width x length mm	Weight kg/piece	Packaging unit	Material number	EAN
Installation Shaft Wall I 90	300 x 300	304 x 304	8.4	1 piece / pack	00759406	4003982551566
	400 x 400	404 x 404	13.4		00759407	4003982551573
	500 x 500	504 x 504	19.5		00759410	4003982551580
	600 x 600	604 x 604	26.4		00759408	4003982551597

Required specifications for ordering

- Dimension of the access panel (width x length)



Videos for Knauf systems and products can be found under the following link:

youtube.com/knauf



The Knauf Infothek App now provides all the current information and documents from Knauf Gips KG at any time and in every location in a clear and comfortable way.

knauf.de/infothek

Knauf Direct

Technical Advisory Service:

knauf-direkt@knauf.com

www.knauf.de

Knauf Gips KG Am Bahnhof 7, 97346 Iphofen, Germany

All technical changes reserved. Only the current printed instructions are valid. The stated information represents current state-of-the-art Knauf technology. The entire state of approved engineering rules, appropriate standards, guidelines, and rules of craftsmanship are not included herewith. These and all application instructions have to be adhered to separately by the installer. Our warranty is expressly limited to our products in flawless condition. All application quantities and delivery amounts are based on empirical data that are not easily transferable to other deviating areas.

All rights reserved. All amendments, reprints and photocopies, including those of excerpts, require our expressed permission.