

HOMESEAL LDS SOLIFIT-2

www.knaufinsulation.com

2-SIDED ADHESIVE TAPE

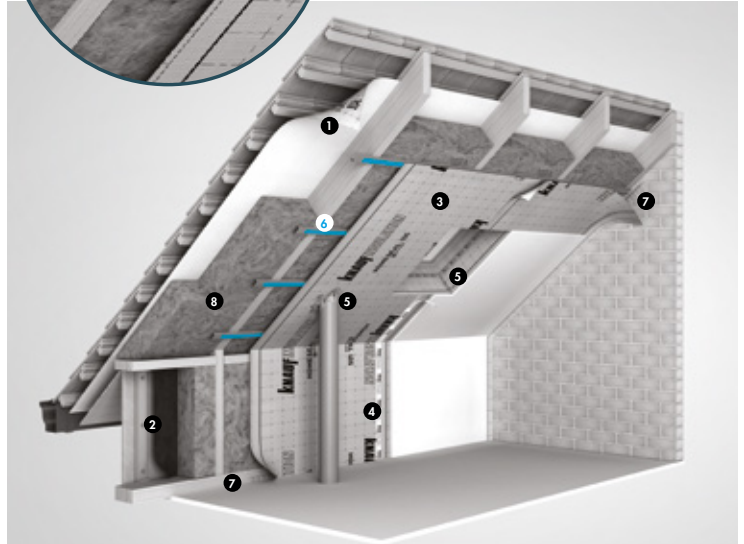
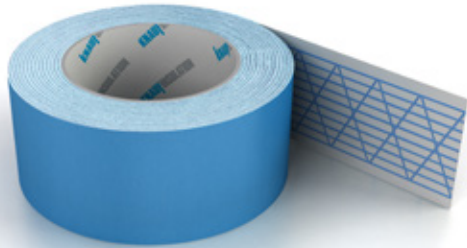

PRODUCT DESCRIPTION

Transparent, elastic modified acrylic double-sided self-adhesive tape reinforced with a blue scrim of oblique threads. Tape with a finger lift on each side for a faster installation. Requires no drying time.

HOMESEAL[®] SYSTEM

Weather membranes

- HOMESEAL LDS 0.02
- 1 HOMESEAL LDS 0.04
- HOMESEAL LDS 0.04 FIXPLUS
- 2 HOMESEAL LDS 0.02 UV
- HOMESEAL LDS 0.02 UV FIXPLUS

Vapour control layers

- HOMESEAL LDS 2
- HOMESEAL LDS 5
- HOMESEAL LDS 35
- HOMESEAL LDS 40
- 3 HOMESEAL LDS 100
- HOMESEAL LDS 100 ALUPLUS
- HOMESEAL LDS 200 ALUPLUS
- HOMESEAL LDS FLEXPLUS

Tapes and sealants

- 4 HOMESEAL LDS SOLIPLAN
- 5 HOMESEAL LDS SOLIFIT-1
- 6 HOMESEAL LDS SOLIFIT-2
- 7 HOMESEAL LDS SOLIMUR 310

Insulation

- 8 KNAUF INSULATION MINERAL WOOL

SPECIFICATIONS

Adhesive tape carrier	Kraftpaper
Adhesive	Modified acrylic, solvent based
Temperature resistance	-40° C to +120° C
Installation temperature	>+5° C, <+ 35° C
Adhesive thickness	110 µm
Total thickness	160 µm
Adhesive width	35 mm
Roll width	45 mm
Roll length	40 m

HOMESEAL LDS SOLIFIT-2

www.knaufinsulation.com

ADDITIONAL INFORMATION

Applications

For use to connect Homeseal LDS vapour control layer membranes to bearing structures such as metal profiles, wooden rafters and purlins, and for connecting to building elements.

Suitable for substrates

- Homeseal LDS vapour control layers,
- Vapour control layers according to EN 13984,
- Wood-based panels with solid surface, oriented strand boards (OSB) according to EN 300,
- Planed timber structures,
- Corrosion free metal surfaces and planed timber elements in the interior,
- Components of PVC and PE. Bonding to plasterboard and gypsum fibre boards,
- Stucco, smooth concrete.

Resistance of the material combinations to ageing

Properly performed adhesions with certified system components are highly resistant to ageing and meet the requirements of ETAG 007 (Guideline for European Technical Approval of timber building kits).

Instructions for use

Please observe the relevant installation guidelines and information provided within the packaging guidance icons. In addition, the relevant standards and recognised rules of technology apply.

Storage

Adhesive tapes should be stored at room temperature and normal humidity (50-70%) and protected from direct sunlight, rain and snow.

APPLICATION GUIDELINES



Place the Homeseal LDS Solifit-2, 2-sided adhesive tape, to connect the vapour control layer to bearing structures and building elements



Use some pressure to ensure the proper adhesion of the tape between the substrates



The tape is for interior use only

ART.: 617637