

FM APPROVALS FOR KNAUF INSULATION ASSEMBLIES

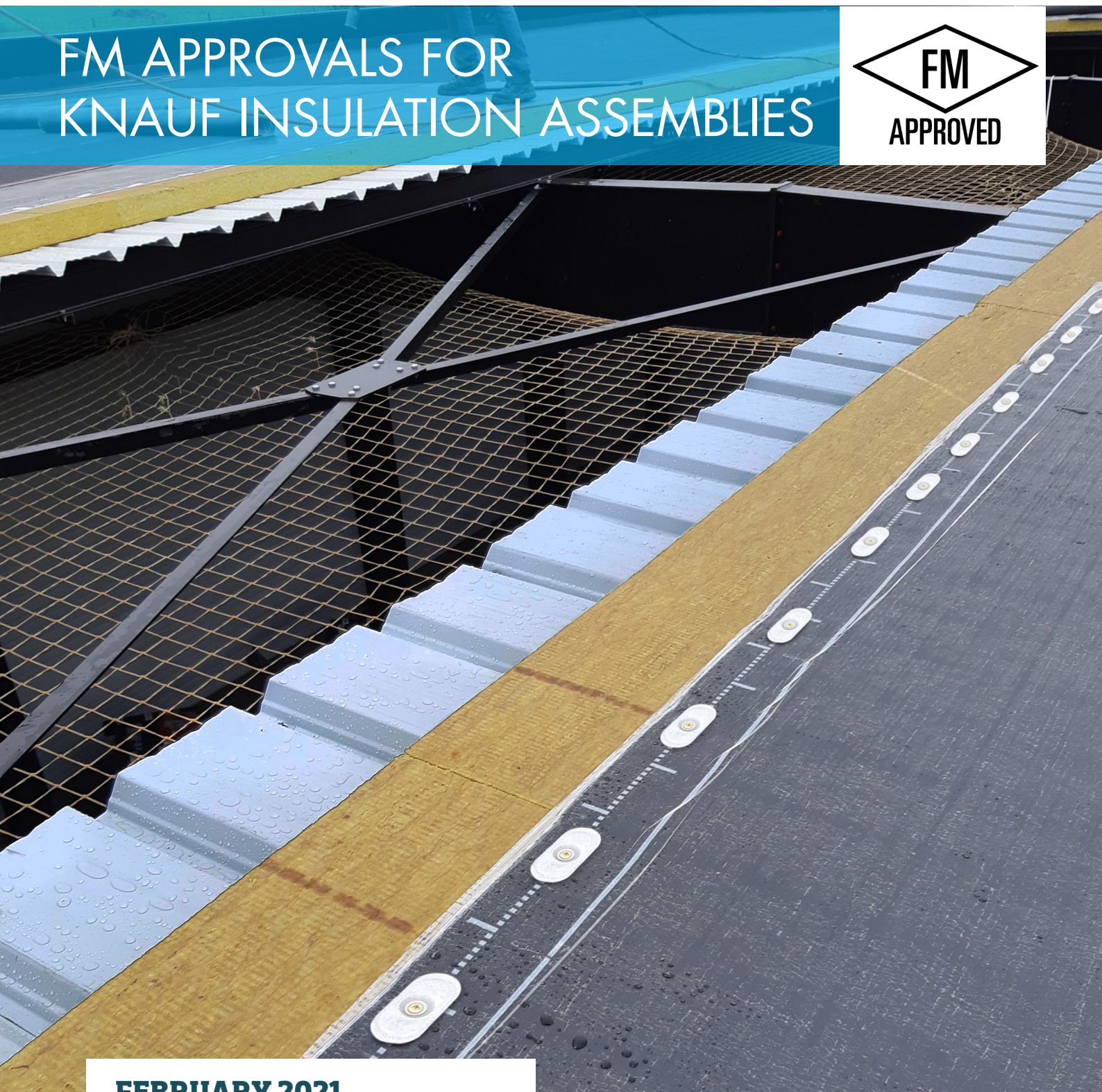

FEBRUARY 2021

KNAUF INSULATION ASSEMBLIES WITH FM APPROVALS TESTING AND CERTIFICATION

WHY DID WE DECIDE TO GO FOR FM APPROVALS?

Roofing systems are the first line of defence in the complete building envelope.

Flat roofs are particularly sensitive to fire and wind load.

For this reason, the entire composition should be designed and assembled in such a way as to prevent eventual losses.

As a global partner, Knauf Insulation chose to invest in FM Approvals certification to deliver to its clients further guarantee of safe flat roof solutions in compliance with an internationally recognised 3rd party certification system.

Most of our flat roof products have been tested in combination with multiple other critical flat roof components against fire and wind in the FM Approvals Fire and Natural Hazard laboratory in West Gloucester / US.

This unique research and testing centre examines the causes of property damage and methods of damage prevention under realistic site conditions, including the assessment of the effects of fire, wind, rain and other natural forces.

The centre belongs to FM Global Insurance, which is a world-leading provider of commercial and industrial property insurance and loss prevention research.



Certificate of Compliance

This certificate is issued for the following:

DDP, DDP-G, DDP2-U, DDP2-U G, DDP2-U PLUS 800, DDP2-U Premium, DDP2-U Base, DDP-X, DDP-X G, SmartRoof Thermal, SmartRoof Norm, SmartRoof Top, SmartRoof Top 1 CTF, SmartRoof Top 2 CTF, SmartRoof Top WE, SmartRoof Top T, Rocksilk Allfix Flat Roof Slab, Rocksilk Flat Roof Slab, SmartRoof All-Fix Thermal

Prepared for:

Knauf Insulation Sprl
Rue du Maestricht 95
Vise, 4600,
Belgium

FM Approvals Class: 4470

Approval Identification: 0003063483 / RR229016 Approval Granted: 8/26/2019

To verify the availability of the Approved product, please refer to www.roofnav.com

Said Approval is subject to satisfactory field performance, continuing Surveillance Audits, and strict conformity to the constructions as shown in RoofNav, an online resource of FM Approvals.

A handwritten signature in dark ink, appearing to read 'Phillip J. Smith'.

Phillip J. Smith
VP - Manager of Materials
FM Approvals
1151 Boston-Providence Turnpike
Norwood, MA 02062



Member of the FM Global Group

KNAUF INSULATION ASSEMBLIES WITH FM APPROVALS TESTING AND CERTIFICATION

WHAT IT MEANS TO BE FM APPROVED?

The FM APPROVED mark is recognized by professionals worldwide: customers of FM Global or investors and multinationals who require the confidence in strong performance criteria for their roofing that FM Approvals certification provides.

To be FM Approved, complete roof assemblies are tested to meet the performance requirement of FM Standard 4470 in terms of:

- Interior fire performance. Knauf Insulation systems passed this pass/fail NFPA 276 test successfully, and have been awarded Class 1 rating.
- Exterior fire performance. When subjected to the ASTM E 108 combustibility test from above the deck, including spread of flame, Knauf Insulation products achieved the highest Class A exterior fire rating.
- The wind performance, static load test in accordance with ANSI/FM Approvals 4474, indicates the strength of the roof assembly. Knauf Insulation assemblies meet FM wind uplift requirements with maximum wind ratings of Class 1-180.

By complying with specific FM Approvals criteria and the latest version of relevant European wind load standards EN 1991-1-4, Knauf Insulation's roofing assemblies are further proven to be fire-safe, wind-resistant and durable for many years.

OUR FM APPROVED ASSEMBLIES

Knauf Insulation has tested a huge range of assemblies to respond to the European market requirements and provides solutions for both single ply and bitumen roofing.

Our assemblies contain only membranes, bitumen or single ply (mechanical fix and adhesive) approved by FM Approvals, as well as fasteners tested successfully for corrosion resistance (ASTM D6294).

Knauf Insulation recommends the use of the RoofNav database to search for dedicated FM Approved roof assemblies with all components such as substrate, vapour barrier, insulation, fasteners, membrane and patterns.

Below we are pleased to present the descriptions of Knauf Insulation FM Approved assemblies. Our certified products are available across Europe. For the complete and updated listing of Knauf Insulation products and details, refer to the RoofNav website, (www.roofnav.com).

If you need assistance regarding Knauf Insulation FM approved products and roof assemblies, contact our [local entities representatives](#).

CONSTRUCTION 1

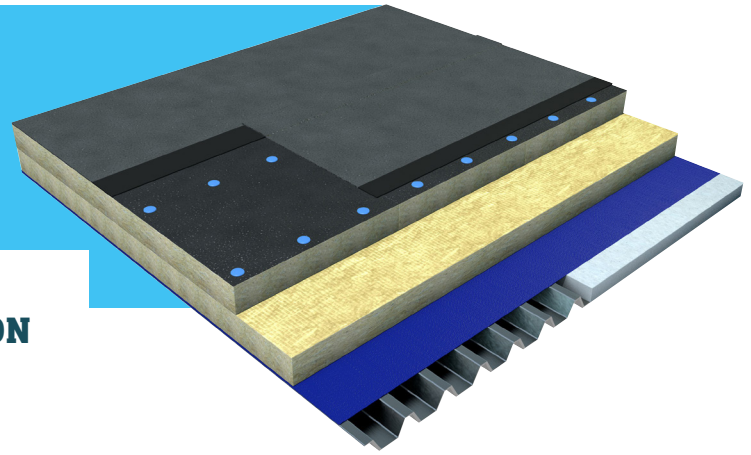

TORCHED BASE AND CAP PLY WITH MECHANICALLY ATTACHED INSULATION

| | |
|---|---|
| Cap Ply: | Soprema NV: Sopralene Global C1 44 GF and Sopralene Global C3 48GF Imper Italia: Paraflex ARD/S and Paralon ARD/S Modified Bitumen |
| Base Ply: | Soprema NV: Soprarock Global SBS 30 TF Imper Italia: Paraflex NT – torch adhered, used with Paraflex ARD/S cap ply Top S modified bitumin – torch adhered, used with Paralon ARD/S Modified Bitumen cap ply |
| Cover Board: | Minimum 60 mm (2.36 in.) thick. Rocksilk Krimpack Allfix Roof Slab SmartRoof All-Fix Thermal |
| Mechanically Attached: (cover board to deck) | Coverboard secured to the deck with stress plates and fasteners applied at a maximum contributory area of 0.2 m ² (2.15 ft ²) per fastener <ul style="list-style-type: none"> SFS Intec: IF-70x70 with IR2-4.8 R75 with BS-6.1 R75 with TI-T25-6.3 OMG: AccuTrac Plate with #12 Standard Roofgrip AccuTrac Plate with #14 Roofgrip AccuTrac Plate with OMG XHD screw AccuTrac Plate with Universal #14 Fastener AccuTrac Plate with CD-10 AccuTrac Plate with OMG #14 Heavy Duty 3 in. Ribbed Galvalume Plate with #12 Standard Roofgrip 3 in. Ribbed Galvalume Plate with #14 Roofgrip 3 in. Ribbed Galvalume Plate with OMG XHD screw 3 in. Ribbed Galvalume Plate with CD-10 3 in. Ribbed Galvalume Plate with Universal #14 Fastener 3 in. Ribbed Galvalume Plate with OMG #14 Heavy Duty Guardian BV: Guardian SPA-7070-D1 plate with Guardian DBT-4.8 Guardian R75 with Guardian BS-4.8 Guardian R75 with Guardian CS-6.1 |
| Insulation (Optional): | One or more layers of minimum 60 mm (2.36 in.) thick insulation. Maximum total thickness of insulation and cover board is 600 mm (23.6 in.) <ul style="list-style-type: none"> DDP DDP-G DDP2-U DDP2-U G DDP2-U PLUS DDP-X DDP-X G SmartRoof Thermal SmartRoof Norm SmartRoof Top SmartRoof Top 1 CTF SmartRoof Top 2 CTF SmartRoof Top WE SmartRoof Top T Rocksilk Krimpack Allfix Roof Slab SmartRoof All-Fix Thermal |
| Vapor Retarder (Optional): | 0.3 mm (0.012 in.) thick generic Polyethylene |
| Deck: | Minimum 22 ga. (0.7493 mm [0.0295 in.]) FM Approved Steel Deck Structural Concrete Deck (only with #14, #15, CD-10, CS 6.1, and TI-T25-6.3 fasteners) |
| Hail: | As Currently Approved in RoofNav |
| ASTM E108: | Class A at 1 in 12 slope: Sopralene Global C1 44 GF, Sopralene Global C3 48GF Class A at 1.5 in 12 slope: Paraflex ARD/S, Paralon ARD/S Modified Bitumen |
| Wind Rating: | 1-90 |



CONSTRUCTION 2

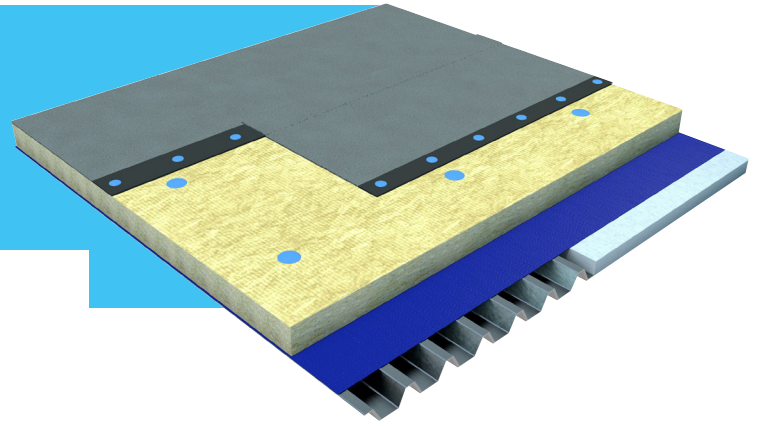

MECHANICALLY ATTACHED SINGLE-PLY COVERS

| | |
|-----------------------------------|--|
| Roof Cover: | Sika Services AG, BU Contractors: Sarnafil TS 77-12, Sarnafil TS 77-15, Sarnafil TS 77-18, Sarnafil TS 77-20, Sikaplan G-12 and Sikaplan G-15 Firestone Building Products Co.: RubberGard LS-FR and UltraPly TPO Protan A/S: Protan SE alwitra GmbH & Co Klaus Gobel: Evalon V Paul Bauder GmbH & Co.: Thermofol-U/M Imperbel SA: Derbigum SP |
| Securement: | As currently Approved in RoofNav |
| Insulation: | One or more layers of minimum 60 mm (2.36 in.) thick insulation. Maximum total thickness of insulation and cover board is 600 mm (23.6 in.) <ul style="list-style-type: none"> • DDP • DDP-G • DDP2-U • DDP2-U G • DDP2-U PLUS • DDP-X • DDP-X G • SmartRoof Thermal • SmartRoof Norm • SmartRoof Top • SmartRoof Top 1 CTF • SmartRoof Top 2 CTF • SmartRoof Top WE • SmartRoof Top T • Rocksilk Krimpact Allfix Roof Slab • SmartRoof All-Fix Thermal |
| Vapor Retarder (Optional): | 0.3 mm (0.012 in.) thick generic Polyethylene |
| Deck: | Minimum 22 ga. (0.7493 mm [0.0295 in.]) FM Approved Steel Deck Structural Concrete Deck (only with #14, #15, CD-10, CS 6.1, and TI-T25-6.3 fasteners) |
| Hail: | As Currently Approved in RoofNav |
| ASTM E108: | Class A at 0.5 in 12 slope: Sarnafil TS 77-12, Sarnafil TS 77-15 Sarnafil TS 77-18, Sarnafil TS 77-20 Thermofol-U/M Derbigum SP Class A at 1 in 12 slope: Evalon V Sikaplan G-12, Sikaplan G-15 Class A at 1.5 in 12 slope: UltraPly TPO Class A at 2 in 12 slope: Protan SE Class A at 0.625 in 12 slope: RubberGard LS-FR |
| Wind Rating: | As currently Approved for the Roof Cover and Securement Combination as shown in RoofNav |



CONSTRUCTION 3

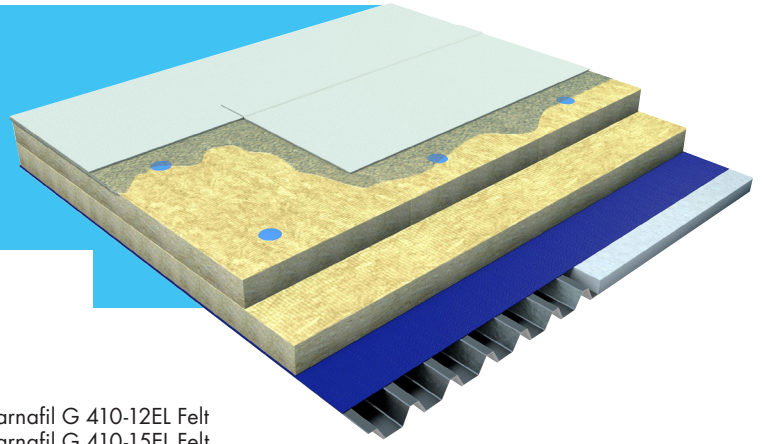

FULLY-ADHERED SINGLE-PLY COVERS WITH FASTENED COVER BOARD

| | |
|---|---|
| Roof Cover: | Sika Services AG, BU Contractors: Sarnafil G 410-12EL Felt Sarnafil G 410-15EL Felt Sarnafil G 410-18EL Felt Sarnafil G 410-20EL Felt Firestone Building Products Co.: RubberGard LS-FR |
| Securement: | Sika Services AG, BU Contractors: Sarnacol 2142S applied to substrate at 0.5 to 1.0 kg/m ² (10 to 20 lbs/sq.) Firestone Building Products Co.: BA-2004 (T) Bonding Adhesive applied at 0.33 L/m ² (0.81 gal/sq.) to both the underside of the roof cover and the substrate |
| Cover Board: | Minimum 60 mm (2.36 in.) thick. Rocksilk Krimpack Allfix Roof Slab SmartRoof All-Fix Thermal |
| Mechanically Attached: (cover board to deck) | Coverboard secured to the deck with stress plates and fasteners applied at a maximum contributory area of 0.2 m ² (2.15 ft ²) per fastener <ul style="list-style-type: none"> • SFS Intec: IF-70x70 with IR2-4.8 R75 with BS-6.1 R75 with TI-T25-6.3 • OMG: AccuTrac Plate with #12 Standard Roofgrip AccuTrac Plate with #14 Roofgrip AccuTrac Plate with OMG XHD screw AccuTrac Plate with Universal #14 Fastener AccuTrac Plate with CD-10 AccuTrac Plate with OMG #14 Heavy Duty 3 in. Ribbed Galvalume Plate with #12 Standard Roofgrip 3 in. Ribbed Galvalume Plate with #14 Roofgrip 3 in. Ribbed Galvalume Plate with OMG XHD screw 3 in. Ribbed Galvalume Plate with CD-10 3 in. Ribbed Galvalume Plate with Universal #14 Fastener 3 in. Ribbed Galvalume Plate with OMG #14 Heavy Duty • Guardian BV: Guardian SPA-7070-D1 plate with Guardian DBT-4.8 Guardian R75 with Guardian BS-4.8 Guardian R75 with Guardian CS-6.1 |
| Insulation: | One or more layers of minimum 60 mm (2.36 in.) thick insulation. Maximum total thickness of insulation and cover board is 600 mm (23.6 in.) <ul style="list-style-type: none"> • DDP • DDP-G • DDP2-U • DDP2-U G • DDP2-U PLUS • DDP-X • DDP-X G • SmartRoof Thermal • SmartRoof Norm • SmartRoof Top • SmartRoof Top 1 CTF • SmartRoof Top 2 CTF • SmartRoof Top WE • SmartRoof Top T • Rocksilk Krimpack Allfix Roof Slab • SmartRoof All-Fix Thermal |
| Vapor Retarder (Optional): | 0.3 mm (0.012 in.) thick generic Polyethylene |
| Deck: | Minimum 22 ga. (0.7493 mm [0.0295 in.]) FM Approved Steel Deck Structural Concrete Deck (only with #14, #15, CD-10, CS 6.1, and TI-T25-6.3 fasteners) |
| Hail: | As Currently Approved in RoofNav |
| ASTM E108: | Class A at 0.5 in 12 slope: RubberGard LS-FR Class A at 1.75 in 12 slope: Sarnafil G 410-12EL Felt, Sarnafil G 410-15EL Felt, Sarnafil G 410-18EL Felt, Sarnafil G 410-20EL Felt |
| Wind Rating: | 1-90 |



CONSTRUCTION 4

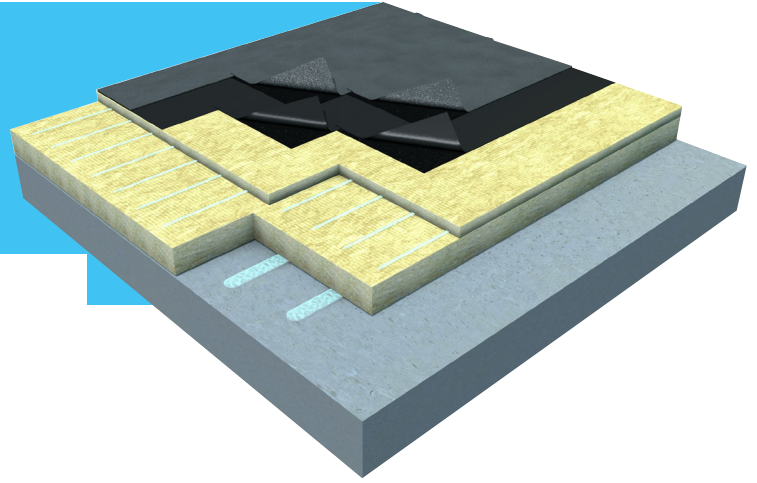

TORCHED BASE AND CAP PLY OVER STRUCTURAL CONCRETE WITH ADHERED INSULATION

| | |
|---------------------|--|
| Cap Ply: | Soprema NV: Sopralene Global C1 44 GF and Sopralene Global C3 48GF Imper Italia: Paraflex ARD/S and Paralon ARD/S Modified Bitumen |
| Base Ply: | Soprema NV: Soprarock Global SBS 30 TF Imper Italia: Paraflex NT – torch adhered, used with Paraflex ARD/S Imper Italia: Top S modified bitumin – torch adhered, used with Paralon ARD/S Modified Bitumen cap ply |
| Cover Board: | Minimum 60 mm (2.36 in.) thick. Rocksilk Krimpact Allfix Roof Slab SmartRoof All-Fix Thermal |
| Securement: | HB Fuller Company: Millennium One Step Foamable Adhesive applied in 13 to 19 mm (0.51 to 0.75 in.) wide ribbons spaced 300 mm (11.8 in.) on center. |
| Insulation: | One or more layers of minimum 60 mm (2.36 in.) thick insulation. Maximum total thickness of insulation and cover board is 600 mm (23.6 in.) <ul style="list-style-type: none"> • DDP • DDP-G • DDP2-U • DDP2-U G • DDP2-U PLUS • DDP-X • DDP-X G • SmartRoof Thermal • SmartRoof Norm • SmartRoof Top • SmartRoof Top 1 CTF • SmartRoof Top 2 CTF • SmartRoof Top WE • SmartRoof Top T • Rocksilk Krimpact Allfix Roof Slab • SmartRoof All-Fix Thermal |
| Securement: | HB Fuller Company: Millennium One Step Foamable Adhesive applied in 13 to 19 mm (0.51 to 0.75 in.) wide ribbons spaced 300 mm (11.8 in.) on center. |
| Deck: | Structural Concrete |
| Hail: | As Currently Approved in RoofNav |
| ASTM E108: | Class A at 1 in 12 slope: Sopralene Global C1 44 GF, Sopralene Global C3 48GF Class A at 1.5 in 12 slope: Paraflex ARD/S, Paralon ARD/S Modified Bitumen |
| Wind Rating: | 1-165 |



CONSTRUCTION 5

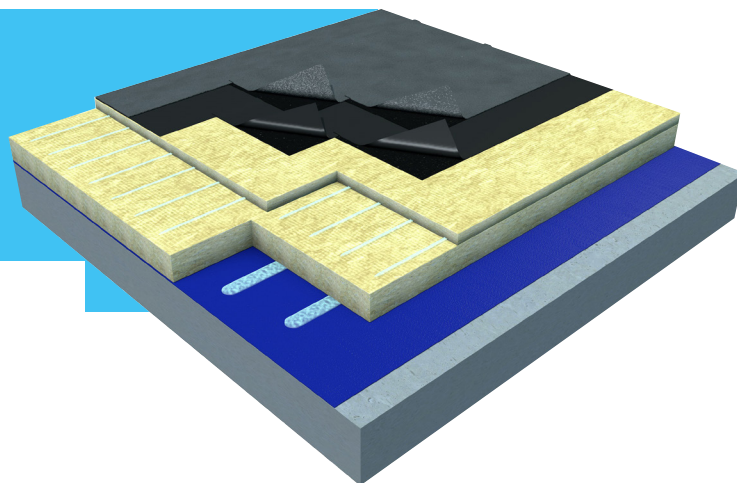

TORCHED BASE AND CAP PLY OVER STRUCTURAL CONCRETE WITH VAPOR RETARDER

| | |
|---|--|
| Cap Ply: | Soprema NV: Sopralene Global C1 44 GF and Sopralene Global C3 48GF Imper Italia: Paraflex ARD/S and Paralon ARD/S Modified Bitumen |
| Base Ply: | Soprema NV: Soprarock Global SBS 30 TF Imper Italia: Paraflex NT – torch adhered, used with Paraflex ARD/S Imper Italia: Top S modified bitumin – torch adhered, used with Paralon ARD/S Modified Bitumen cap ply |
| Cover Board: | Minimum 60 mm (2.36 in.) thick. Rocksilk Krimpact Allfix Roof Slab SmartRoof All-Fix Thermal |
| Securement: | HB Fuller Company: Millennium One Step Foamable Adhesive applied in 13 to 19 mm (0.51 to 0.75 in.) wide ribbons spaced 300 mm (11.8 in.) on center. |
| Insulation: | One or more layers of minimum 60 mm (2.36 in.) thick insulation. Maximum total thickness of insulation and cover board is 600 mm (23.6 in.) <ul style="list-style-type: none"> • DDP • DDP-G • DDP2-U • DDP2-U G • DDP2-U PLUS • DDP-X • DDP-X G • SmartRoof Thermal • SmartRoof Norm • SmartRoof Top • SmartRoof Top 1 CTF • SmartRoof Top 2 CTF • SmartRoof Top WE • SmartRoof Top T • Rocksilk Krimpact Allfix Roof Slab • SmartRoof All-Fix Thermal |
| Securement: | HB Fuller Company: Millennium One Step Foamable Adhesive applied in 13 to 19 mm (0.51 to 0.75 in.) wide ribbons spaced 300 mm (11.8 in.) on center. |
| Vapor Retarder Securement Primer | <ul style="list-style-type: none"> • Sopravap Stick A15 • Sopravap Stick C15 • Self-adhered • Elastocol 600 |
| Deck: | Structural Concrete |
| Hail: | As Currently Approved in RoofNav |
| ASTM E108: | Class A at 1 in 12 slope: Sopralene Global C1 44 GF, Sopralene Global C3 48GF Class A at 1.5 in 12 slope: Paraflex ARD/S, Paralon ARD/S Modified Bitumen |
| Wind Rating: | 1-135 |



CONSTRUCTION 6

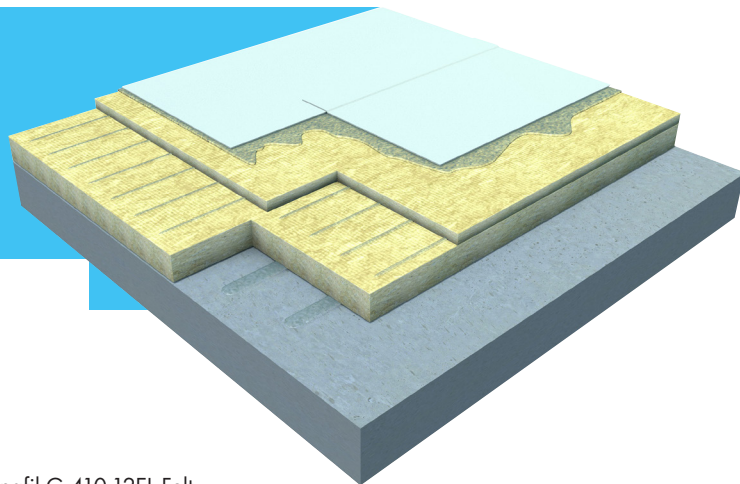

FULLY-ADHERED SINGLE PLY OVER STRUCTURAL CONCRETE WITH ADHERED INSULATION

| | |
|---------------------|--|
| Roof Cover: | Sika Services AG, BU Contractors: Sarnafil G 410-12EL Felt Sarnafil G 410-15EL Felt Sarnafil G 410-18EL Felt Sarnafil G 410-20EL Felt Firestone Building Products Co.: RubberGard LS-FR |
| Securement: | Sika Services AG, BU Contractors: Sarnacol 2142S applied to substrate at 0.5 to 1.0 kg/m ² (10 to 20 lbs/sq.) Firestone Building Products Co.: BA-2004 (T) Bonding Adhesive applied at 0.33 L/m ² (0.81 gal/sq.) to both the underside of the roof cover and the substrate |
| Cover Board: | Minimum 60 mm (2.36 in.) thick. Rocksilk Krimpact Allfix Roof Slab SmartRoof All-Fix Thermal |
| Securement: | HB Fuller Company: Millennium One Step Foamable Adhesive applied in 13 to 19 mm (0.51 to 0.75 in.) wide ribbons spaced 300 mm (11.8 in.) on center. |
| Insulation: | One or more layers of minimum 60 mm (2.36 in.) thick insulation. Maximum total thickness of insulation and cover board is 600 mm (23.6 in.) <ul style="list-style-type: none"> • DDP • DDP-G • DDP2-U • DDP2-U G • DDP2-U PLUS • DDP-X • DDP-X G • SmartRoof Thermal • SmartRoof Norm • SmartRoof Top • SmartRoof Top 1 CTF • SmartRoof Top 2 CTF • SmartRoof Top WE • SmartRoof Top T • Rocksilk Krimpact Allfix Roof Slab • SmartRoof All-Fix Thermal |
| Securement: | HB Fuller Company: Millennium One Step Foamable Adhesive applied in 13 to 19 mm (0.51 to 0.75 in.) wide ribbons spaced 300 mm (11.8 in.) on center. |
| Deck: | Structural Concrete |
| Hail: | As Currently Approved in RoofNav |
| ASTM E108: | Class A at 0.5 in 12 slope: RubberGard LS-FR Class A at 1.75 in 12 slope: Sarnafil G 410-12EL Felt, Sarnafil G 410-15EL Felt, Sarnafil G 410-18EL Felt, Sarnafil G 410-20EL Felt |
| Wind Rating: | 1-180 |



CONSTRUCTION 7

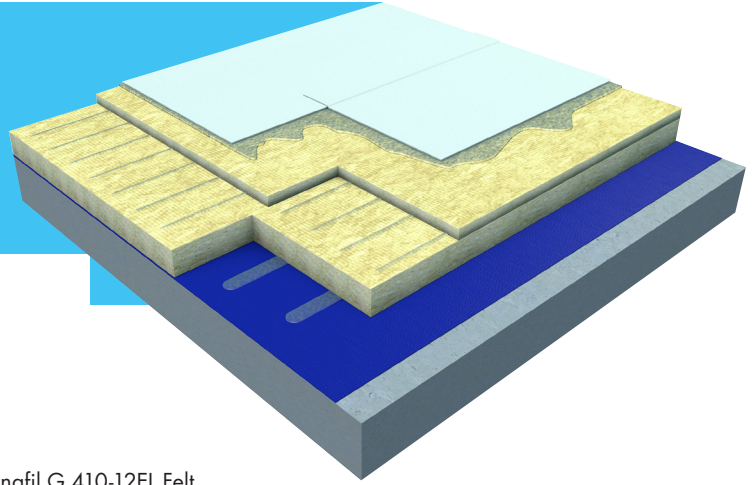

FULLY-ADHERED SINGLE PLY OVER STRUCTURAL CONCRETE WITH VAPOR RETARDER

| | |
|---|--|
| Roof Cover: | Sika Services AG, BU Contractors: Sarnafil G 410-12EL Felt Sarnafil G 410-15EL Felt Sarnafil G 410-18EL Felt Sarnafil G 410-20EL Felt Firestone Building Products Co.: RubberGard LS-FR |
| Securement: | Sika Services AG, BU Contractors: Sarnacol 2142S applied to substrate at 0.5 to 1.0 kg/m ² (10 to 20 lbs/sq.) Firestone Building Products Co.: BA-2004 (T) Bonding Adhesive applied at 0.33 L/m ² (0.81 gal/sq.) to both the underside of the roof cover and the substrate |
| Cover Board: | Minimum 60 mm (2.36 in.) thick. Rocksilk Krimpack Allfix Roof Slab SmartRoof All-Fix Thermal |
| Securement: | HB Fuller Company: Millennium One Step Foamable Adhesive applied in 13 to 19 mm (0.51 to 0.75 in.) wide ribbons spaced 300 mm (11.8 in.) on center. |
| Insulation: | One or more layers of minimum 60 mm (2.36 in.) thick insulation. Maximum total thickness of insulation and cover board is 600 mm (23.6 in.) <ul style="list-style-type: none"> • DDP • DDP-G • DDP2-U • DDP2-U G • DDP2-U PLUS • DDP-X • DDP-X G • SmartRoof Thermal • SmartRoof Norm • SmartRoof Top • SmartRoof Top 1 CTF • SmartRoof Top 2 CTF • SmartRoof Top WE • SmartRoof Top T • Rocksilk Krimpack Allfix Roof Slab • SmartRoof All-Fix Thermal |
| Securement: | HB Fuller Company: Millennium One Step Foamable Adhesive applied in 13 to 19 mm (0.51 to 0.75 in.) wide ribbons spaced 300 mm (11.8 in.) on center. |
| Vapor Retarder Securement Primer | <ul style="list-style-type: none"> • Sopravap Stick A15 • Sopravap Stick C15 • Self-adhered • Elastocol 600 |
| Deck: | Structural Concrete |
| Hail: | As Currently Approved in RoofNav |
| ASTM E108: | Class A at 0.5 in 12 slope: RubberGard LS-FR Class A at 1.75 in 12 slope: Sarnafil G 410-12EL Felt, Sarnafil G 410-15EL Felt, Sarnafil G 410-18EL Felt, Sarnafil G 410-20EL Felt |
| Wind Rating: | 1-150 |



WHERE TO FIND US

Knauf Insulation is one of the world's largest manufacturers of insulation products and solutions. With over 40 years of experience in the industry, we represent one of the fastest growing and most respected names in insulation worldwide. Knauf Insulation is present in more than 40 countries and has 27 manufacturing sites in 15 countries.

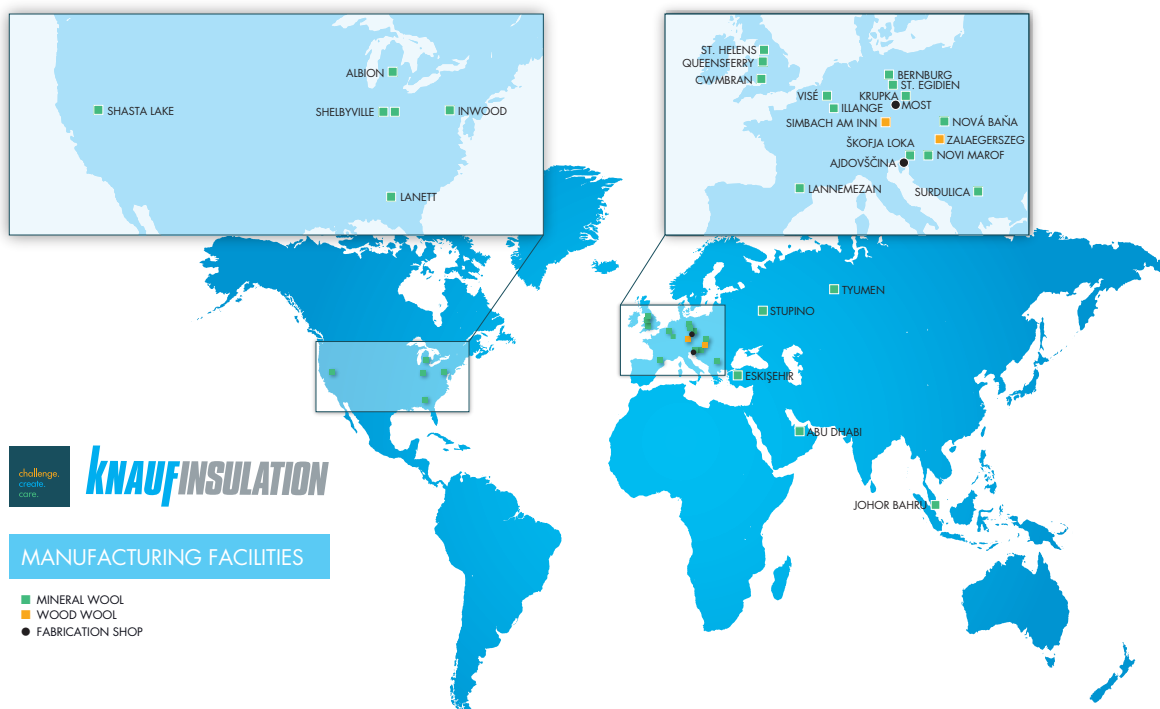

MANUFACTURING FACILITIES

- MINERAL WOOL
- WOOD WOOL
- FABRICATION SHOP

GLOSSARY

ASSEMBLY NUMBER

It is a unique number assigned to each RoofNav assembly. A valid assembly number consists of three numbers separated by hyphens. The number of digits in each section may vary as in the following examples: 1-234-5; 123-45678-9; 123456-1-12345; etc.

ASTM

It is the American Society for Testing Materials that sets standards for a wide variety of materials, including roofing.

CAP PLY

It is a layer in a multi-ply assembly cover contains cap sheet products.

BASE PLY

It is the bottom or first ply in a built-up roof membrane when additional plies are to be subsequently installed. It differs from a base sheet in that a base ply is only used within a multi-ply cover. A base ply cannot be mechanically attached.

COVER BOARD

It is a board stock product used over insulation. A cover board is only applied as the top layer of a multilayer insulation assembly.

FASTENER

It is a mechanical securement device used alone or in combination with a stress distributor to secure various components of a roof assembly. Fasteners are FM Approved for various applications within a completed roof.

ROOF ASSEMBLY

It is a term used to describe all of the roof components including structural roof deck.

ROOFNAV

It is the global database allow extensive research of approved products and assemblies.

SUBSTRATE

It is the surface upon which a component is applied (e.g., in roofing, the structural deck or insulation).

TORCH APPLIED

It is a method used in the installation of polymer modified bitumen membranes characterized by using open flame propane torch equipment.

VAPOR RETARDER

It is a layer or layers of material, or a laminate, used to appreciably reduce the flow of water vapour into a roof assembly.

WIND UPLIFT

It is the force generated by wind on a roof system or components in a roof system resulting from wind-induced pressure.

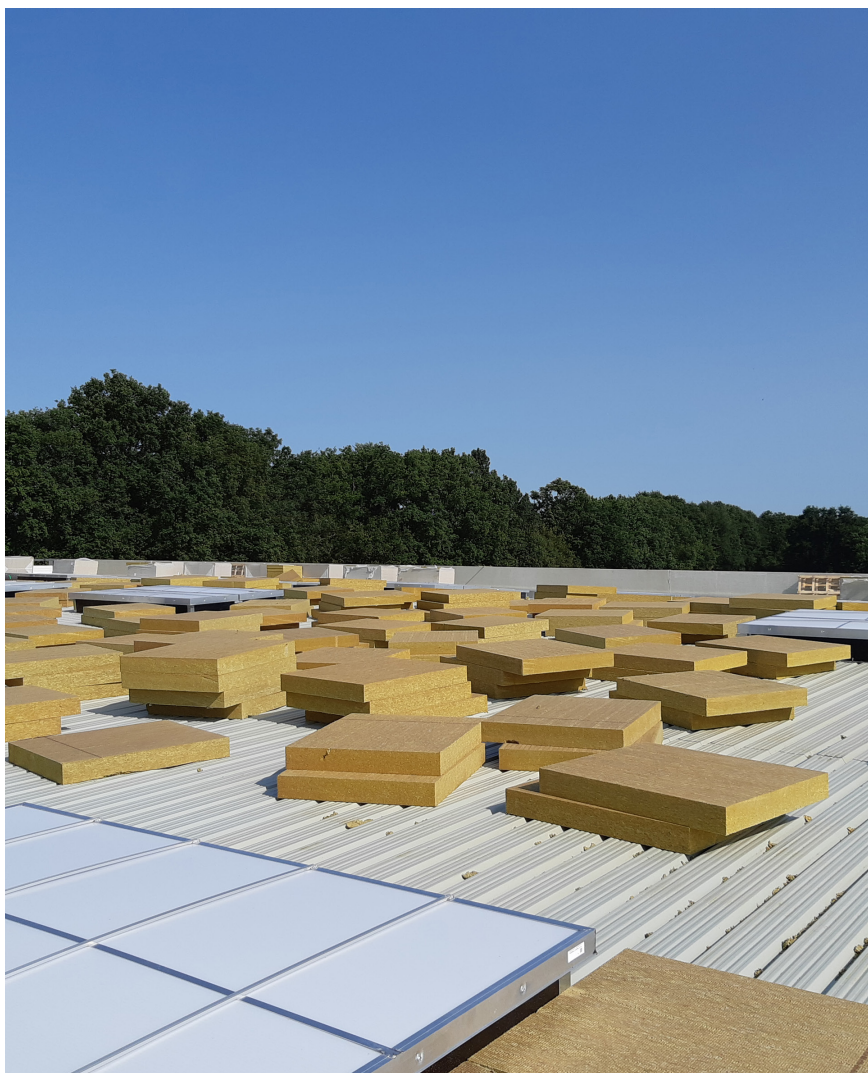

Knauf Insulation SPRL
Rue de Maëstricht 95 – 4600 Visé – Belgium
www.knaufinsulation.com

All rights reserved, including those of photomechanical reproduction and storage in electronic media. Extreme caution was observed when putting together and processing the information, texts and illustrations in this document. Nevertheless, errors cannot be fully ruled out. The publisher and editors cannot assume legal responsibility or any liability whatsoever for incorrect information and the consequences thereof. The publisher and editors will be grateful for improvement suggestions and details of possible errors pointed out.

challenge.
create.
care.