

Plastic Toggle Dowel

Technical Data Sheet 12/2023

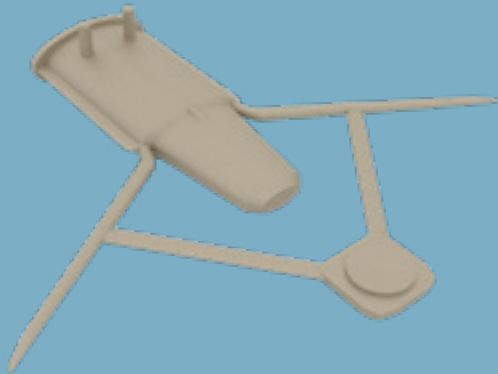

Plastic Toggle Dowel

Dowel

Product Description

Dowel used for hanging low-weight and fixed objects on one layered gypsum board applications.

Standards referred to

-

Fields of Applications

- Hanging loads on gypsum wall partitions
- Hanging loads on gypsum suspending ceilings
- Hanging loads on gypsum wall claddings

Properties

- Easy and clean installation

Technical Data

Description	Weight (kg/box)	Packaging (pcs./box)	Material Number
Plastic Toggle Dowel N:3	1	500	149777

System Performance Values

Performance values as sound insulation, fire resistance etc. may differ acc. to the drywall system to be applied. Please check the performance values of the drywall systems;

[Knauf Technical Website](#)
[Document Center](#)

Application

Application should be done acc. to the applicable standards (TS 1475) and acc. to the Knauf Technical Brochures of the respective drywall system.

▶ 444 YAPI - 9274

▶ www.knauf.com.tr / www.teknik.knauf.com.tr

▶ teknik@knauf.com

Center: Knauf Moment Beştepe Office, Beştepe Mah. 32.Cadde No:1/212-218 06560 Beştepe-Yenimahalle
/ ANKARA Tel: 0312 297 0100 Faks: 0312 266 4506