



KNAUF SHEETROCK® WETSTOP™

Superior Moisture-Resistant

Through the development of extensive research by Knauf, Knauf Sheetrock® Wetstop™ is the latest advancement in moisture-resistant plasterboard range.

KNAUF

Build on us.

Advantages



Moisture-Resistant

- Low water absorption board with less than 5% water absorption rate. Ideal for non-direct water exposure wet area wall and wet area ceiling application.



Aesthetics

- Seamless and smooth finish.



Consistent Quality

- Produced in a state-of-the-art ISO 9001 certified plant.



- **Plasterboard designed to offer decorative finish** with moisture-resistant performance.

Product Data

Product Name	Knauf Sheetrock® Wetstop™		Product Standard	BS EN 520:2004
Thickness (mm)	9.5	12.5	Product Testing	BS 476 Part 6
Nominal Weight (kg/m ²)	6.60	8.30		BS 476 Part 7
Nominal Density (kg/m ³)	695	664	Edge Detail	Tapered
Size*(mm)	1220mm X 2440mm (4' X 8')			

Please refer to Knauf representative for other board sizes.

Application

Suitable for non direct water exposure wet area wall and wet area ceiling application.

Systems

Knauf Moisture-Resistant Ceiling System with Knauf Sheetrock® Wetstop™ 9.5mm

NOTE:

- Max. Drop Ceiling 1500mm
- Not recommended for external use
- Recommended ceiling batten spacing is strictly for Knauf Ceiling Batten R203 only

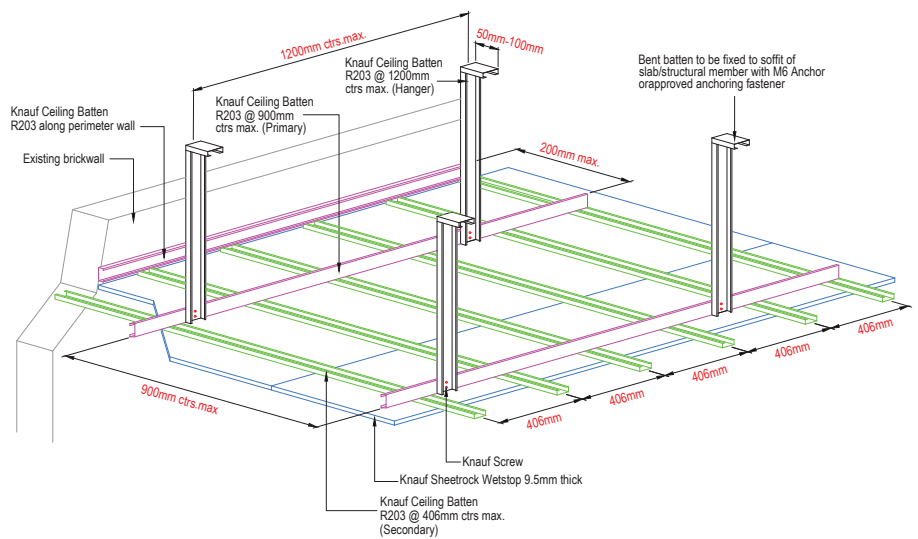

Non-direct Water Exposure Wet Area Wall with Knauf Sheetrock® Wetstop™ 12.5mm

NOTE:

1. Additional structural support or framing to be advised by specialist/consultant for wall height >3000mm or width >3600mm.
2. All parts and components to follow manufacturers detail specification.
3. FRL: non-fire rated
4. Acoustic: Varies
5. Waterproof by others (special attention to be paid to joint between kerb and board as advised by specialist)

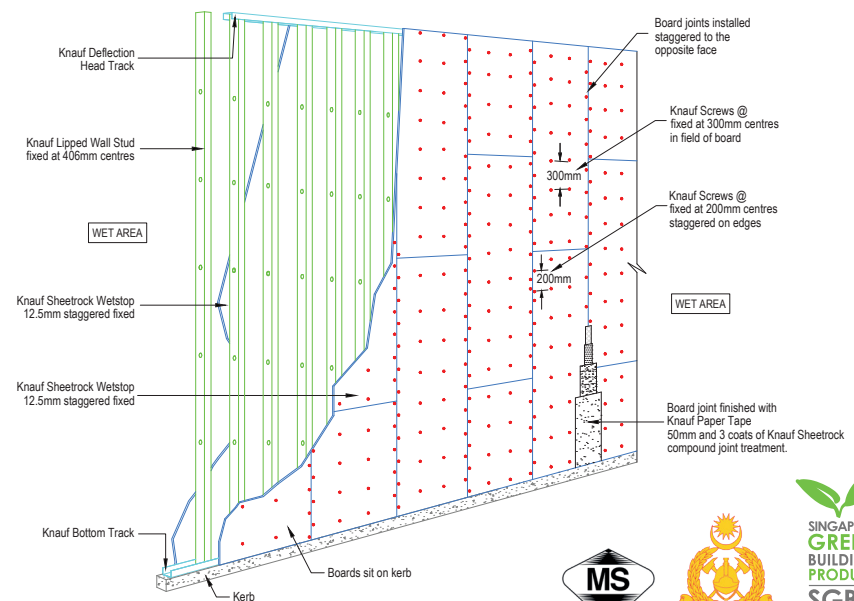

KNAUF METAL PRODUCTS:

Shall be free from red rust by 50%, in accordance with ASTM D610-08 (2019) - Standard Practice for Evaluating the Degree of Rusting on Painted Steel Surfaces.



Knauf Sdn. Bhd

Lot 606, Jalan Lagoon Selatan, 47500 Subang Jaya, Selangor, Malaysia

T: (03) 5629 2000 E: contactusmy@knauf.com W: www.knauf.com

© 2024 KNAUF. All rights reserved. KNAUF and WETSTOP are trademarks of Knauf Sdn. Bhd. or one or more of its affiliates. SHEETROCK is a trademark owned by United States Gypsum Company and used under license. Information provided is for reference purpose only. Due care has been taken to ensure accuracy at time of publication. Products, specifications, and requirements may vary according to geographical locations and applications. As each project is unique, please contact your nearest Knauf representative for further assessment.



Scan to visit our website

