



## **Knauf** Alux Corner Tape

Knauf Alux Corner Tape is a flexible paper tape roll with metal strip reinforcements. The tape is bent inwards or outwards from the middle and is applied to interior or exterior corners to reinforce the edges of drywall applications such as partitions, ceilings, wall linings. Due to its flexibility, the Knauf Alux Corner Tape can also be used on curved applications with ease.

Feature	measurement
Tape Width	50 mm
Tape Length	30 m

External Corner Protection Detail

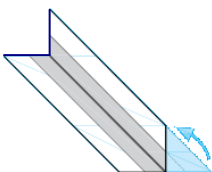

Internal Corner Protection Detail

