

# Knauf StandardShield

Product Data Sheet (01/2025)

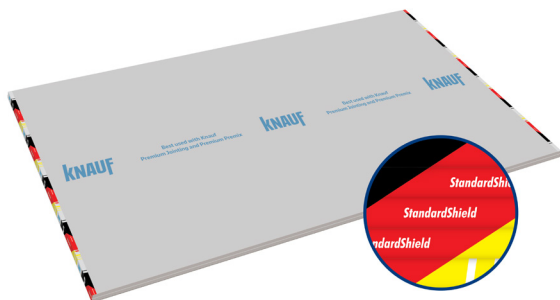

Knauf StandardShield is a regular gypsum board for internal wall linings, partitions and ceilings and is suitable for a wide range of common applications.

PHYSICAL PROPERTIES		
Thickness and Nom. Weight	9 mm 12 mm 16 mm	5.3 kg/m <sup>2</sup> 7.6 kg/m <sup>2</sup> 10 kg/m <sup>2</sup>
Length x Width	1220 mm x 2440 mm	
Edge	Tapered, Squared	
Color	White	

## KEY FEATURES

- **Non-combustible & fire resistant:** Complies with **ASTM E1360** and has Class A Surface burning characteristics per **ASTM E84**
- **Low VOC:** Better for indoor air quality
- **Paper finish:** Ready to receive paint
- **Low thermal conductivity:** Helps insulate heat to maintain cooler indoor temperature
- **Low VOC:** Emits less than 20 µg/m<sup>2</sup>-hr of TVOC for better indoor air quality, as tested per **ASTM D5116**
- **Manufactured in accordance with ASTM standards:**
  - ▶ **ASTM C1396** - Standard Specification for Gypsum Board
  - ▶ **ASTM E84** - Standard Test Method for Surface Burning Characteristics of Building Materials
  - ▶ **ASTM E1360** - Standard Test Method for Behavior of Materials in a Vertical Tube Furnace at 750°C.
  - ▶ **ASTM D5116** - Standard Test Method for Small-Scale Organic Emissions from Indoor Materials/Products
- **Environmental Safety:** Contains no hazardous substances; made using eco-friendly processes

## APPLICATIONS

- Non-fire rated interior partition, ceiling and cladding applications
- New construction, repair and renovation projects
- Recommended as interior face layer for use over old wall and ceiling surfaces

- Recommended as an additional layer for improving sound insulation in double layered wood or steel frames partitions.

### Limitations:

- Avoid exposure to sustained temperatures exceeding 40 °C and 95% RH
- Avoid exposure to excessive, repetitive, or continuous humidity, chemical fumes, freezing temperature, corrosive substance or vibration before, during, and after installation.
- Ensure wall, floor cavities, and enclosed areas are dry before closing up or applying finishes.

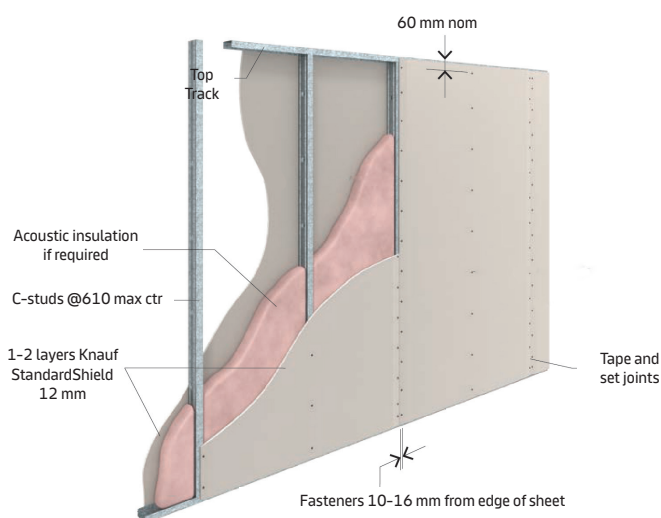

## KNAUF PLASTERBOARD INSTALLATION SYSTEM

This system ensures you maximize the key features of the product and achieve the best results that boost the structural integrity of your project. See the [Systems+ Manual](#) for your detailed user guide.

## INSTALLATION

- **Frame Installation:** Ensure frames are properly installed, spaced, and plumbed. Refer to ASTM C840 for detailed spacing guidelines.
- **Panel Placement:** Install panels with the side facing out, aligning them lightly at edges without forcing. Attach wall panels starting from open (unsupported) stud flange edges.
- **Joint Positioning:** Keep vertical joints at least 200mm from openings.
- **Fastening Guidelines:** Position screws 10–16 mm from edges, flush with the surface without breaking the paper.
  - ▶ Fasten screws no more than 200 mm apart at edges and 300 mm on field.
- **Finishing Touches:** Use gypsum jointing compound to finish fastener heads, joints, and corners.
  - ▶ Level 4 finish is recommended for public areas.



## FINISHING AND DECORATING

- **Use Knauf jointing compounds** for high-quality finishes.
- **Choose the appropriate level of finish** per ASTM C840:
  - ▶ Level 1: Minimal finish for non-public view areas.
  - ▶ Level 2: Basic finish for concealed surfaces.
  - ▶ Level 3: Smooth finish for surfaces to be painted.
  - ▶ Level 4: Standard finish for publicly visible areas.
- ▶ Level 5: High gloss finish for critical lighting conditions.
- **Prepare surfaces by cleaning and drying** before applying joint compounds and finishes.
- **Follow paint manufacturer guidance** for priming and painting.
- **Skim coat panels** where critical lighting or glossy paint is applied to equalize texture differences.

## PERFORMANCE

Knauf StandardShield has undergone rigorous testing to ensure it meets high standards for performance and durability. Here's a summary of the test results along with the benefits of each aspect:

Test	Results	ASTM C1396 Requirement		Benefits
		9 mm	12 mm	
Flexural Strength – Longitudinal	Passed	≥ 322	≥ 447	Provides durability and resistance to bending forces, allowing the plasterboard to withstand structural loads and impacts without sagging or breaking
Flexural Strength – Transverse	Passed	≥ 109	≥ 150	
Hardness	Passed	≥ 49 N	≥ 49 N	Provides resistance to surface damage, helping walls maintain their appearance and integrity in high-traffic areas
Nail Pull Resistance	Passed	≥ 235 N	≥ 322 N	Secures fastening of fixtures and fittings, preventing tearing and enhancing the stability of installations.
Humidified Deflection	Passed	< 483 mm	3 mm	Helps maintain shape and structural integrity even in humid conditions, making it ideal for use in moisture-prone areas like kitchens and bathrooms

\*Knauf gypsum boards are manufactured in accordance with ASTM C1396

## GENERAL HANDLING TIPS

- Always use Personal Protective Equipment (PPE) during handling.
- To safely carry a gypsum board, two people should hold it at both ends.
- The gypsum board should rest on the carriers' shoulders while being carried.
- Use both feet to turn instead of twisting your waist or back.
- Ensure gypsum boards are securely positioned on pallets.

### UNLOADING WITHOUT FORKLIFT TRUCKS

- A minimum of two people is required to manually unload the gypsum boards.
- One person must remain inside the truck to hand over the boards to the others on the ground.
- While carrying gypsum boards, ensure they rest on the carriers' shoulders.

### UNLOADING USING FORKLIFT TRUCKS

- Use a forklift truck with a minimum capacity of 3.5 tons to unload gypsum boards from the delivery truck.
- The unloading should be performed by a certified forklift operator.
- Position the forklift's "forks" between the billets. Secure proper placement of the boards to avoid accidents.
- Prepare billets in the desired storage location beforehand.

## PROPER STORAGE

- Store gypsum boards in a covered area, free from water leaks and excessive moisture. Boards should be kept in neat, flat stacks off the ground to prevent sagging and minimize damage to edges and surfaces.
- Position billets at right angles to the gypsum boards, with stacking supports spaced no more than 600 mm apart. Use five evenly spaced billets.
- The length of the billets should match the length of the gypsum board to properly support its weight.
- Gypsum boards can be stacked up to a maximum of five layers, with the following maximum number of sheets per layer:

9 mm - 110 sheets  
 12 mm - 86 sheets  
 16 mm - 70 sheets

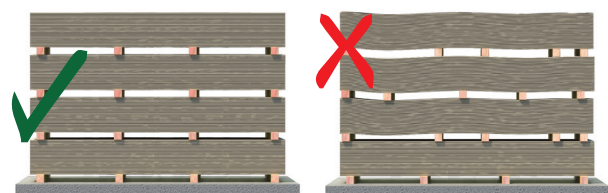

# Submittal Sheet

PROJECT INFORMATION	
Project Name	
Project Location	
Contractor Name	
Date of Submission	

REVIEW AND APPROVAL SECTION				
Reviewer Name and Signature				
Product Name	Approved	With Revisions	Rejected	For Further Deliberation
<b>FOR INTERIOR</b>				
<i>Gypsum Boards</i>				
StandardShield	<input type="checkbox"/>	<input type="checkbox"/>	<input type="checkbox"/>	<input type="checkbox"/>
SpanShield	<input type="checkbox"/>	<input type="checkbox"/>	<input type="checkbox"/>	<input type="checkbox"/>
MoistureShield	<input type="checkbox"/>	<input type="checkbox"/>	<input type="checkbox"/>	<input type="checkbox"/>
FireShield	<input type="checkbox"/>	<input type="checkbox"/>	<input type="checkbox"/>	<input type="checkbox"/>
DenseShield	<input type="checkbox"/>	<input type="checkbox"/>	<input type="checkbox"/>	<input type="checkbox"/>
MultiShield	<input type="checkbox"/>	<input type="checkbox"/>	<input type="checkbox"/>	<input type="checkbox"/>
EchoStop	<input type="checkbox"/>	<input type="checkbox"/>	<input type="checkbox"/>	<input type="checkbox"/>
<i>Compounds &amp; Finishing</i>				
Premium Jointing	<input type="checkbox"/>	<input type="checkbox"/>	<input type="checkbox"/>	<input type="checkbox"/>
Premium Premix	<input type="checkbox"/>	<input type="checkbox"/>	<input type="checkbox"/>	<input type="checkbox"/>
Paper Tape	<input type="checkbox"/>	<input type="checkbox"/>	<input type="checkbox"/>	<input type="checkbox"/>
<b>FOR EXTERIOR</b>				
<i>Cement Board</i>				
Aquapanel	<input type="checkbox"/>	<input type="checkbox"/>	<input type="checkbox"/>	<input type="checkbox"/>
Notes				

