

## Rocksilk® Soffit Linerboards

February 2026

Build on us.

Rocksilk® Soffit  
Linerboard Standard (Faced)

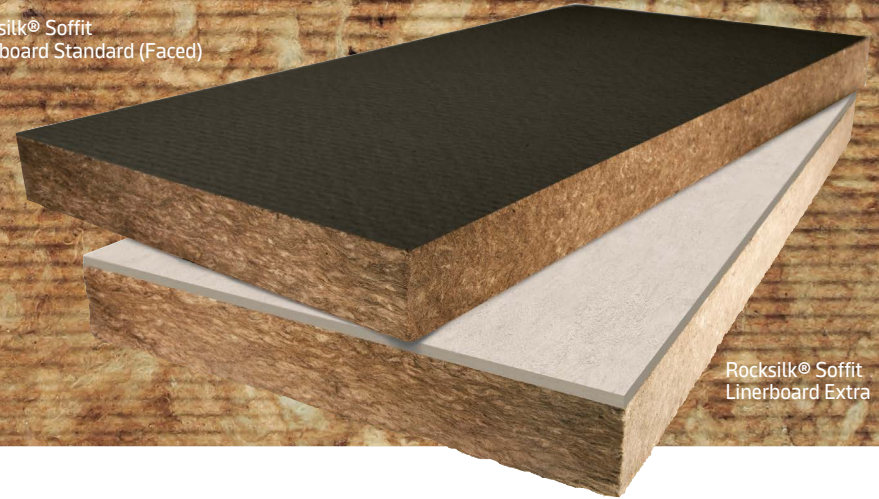

Rocksilk® Soffit  
Linerboard Extra

### Description

Rocksilk® Soffit Linerboard Standard and Extra are rock mineral wool slabs, designed to insulate structural soffits in applications such as car parks.

They are non-combustible with the best possible Euroclass A1 reaction to fire classification, and are manufactured using our unique plant-based binder, ECOSE® Technology.

### Benefits

- › Rocksilk® Soffit Linerboard Extra is impact-resistant due to its cementitious facing board, making it ideal for semi-exposed environments.
- › Provide a solution to upgrade thermal performance of existing floors without reducing floor height.
- › Can be installed without the need to access areas above the floor.
- › Manufactured from mineral wool which provides the best levels of sound absorption and reduction compared to other mainstream insulants to reduce the sound transfer between storeys.
- › Available with optional fixings which match the colour of Rocksilk® Soffit Linerboard Standard and Extra.



Rocksilk® Soffit  
Linerboard Standard  
(Unfaced)



NON-COMBUSTIBLE  
INSULATION



# Rocksilk® Soffit Linerboards

## Technical Specifications

### ROCKSILK® SOFFIT LINERBOARD EXTRA

Thickness (mm)	Thermal conductivity (W/mK)	Thermal resistance (m <sup>2</sup> K/W)	Length (mm)	Width (mm)	Slabs per pack	Slabs per pallet	Area per pack (m <sup>2</sup> )	GWP A1-A3 (kgCO <sub>2</sub> e/m <sup>2</sup> )	GWP A1-C4 (kgCO <sub>2</sub> e/m <sup>2</sup> )	GWP A1-A3 (kgCO <sub>2</sub> e/kg)	GWP A1-C4 (kgCO <sub>2</sub> e/kg)	Pallet product code
220/6*	0.034 / 0.24	6.45	1200	600	n/a	10	7.200	23.40	26.88	1.33	1.53	682465
185/6*	0.034 / 0.24	5.45	1200	600	n/a	12	8.640	19.68	22.61	1.33	1.53	682466
160/6*	0.034 / 0.24	4.70	1200	600	n/a	12	8.640	17.02	19.55	1.33	1.53	682455
130/6*	0.034 / 0.24	3.80	1200	600	n/a	18	12.960	13.83	15.89	1.33	1.53	682453

### ROCKSILK® SOFFIT LINERBOARD STANDARD (FACED)

Thickness (mm)	Thermal conductivity (W/mK)	Thermal resistance (m <sup>2</sup> K/W)	Length (mm)	Width (mm)	Slabs per pack	Slabs per pallet	Area per pack (m <sup>2</sup> )	GWP A1-A3 (kgCO <sub>2</sub> e/m <sup>2</sup> )	GWP A1-C4 (kgCO <sub>2</sub> e/m <sup>2</sup> )	GWP A1-A3 (kgCO <sub>2</sub> e/kg)	GWP A1-C4 (kgCO <sub>2</sub> e/kg)	Pallet product code
220	0.034	6.45	1200	600	n/a	20	14.400	23.40	26.88	1.33	1.53	469973
185	0.034	5.40	1200	600	n/a	28	20.160	19.68	22.61	1.33	1.53	672812
160	0.034	4.70	1200	600	n/a	32	23.040	17.02	19.55	1.33	1.53	675216
130	0.034	3.80	1200	600	n/a	40	28.800	13.83	15.89	1.33	1.53	675217

### ROCKSILK® SOFFIT LINERBOARD STANDARD (UNFACED)

Thickness (mm)	Thermal conductivity (W/mK)	Thermal resistance (m <sup>2</sup> K/W)	Length (mm)	Width (mm)	Slabs per pack	Slabs per pallet	Area per pack (m <sup>2</sup> )	GWP A1-A3 (kgCO <sub>2</sub> e/m <sup>2</sup> )	GWP A1-C4 (kgCO <sub>2</sub> e/m <sup>2</sup> )	GWP A1-A3 (kgCO <sub>2</sub> e/kg)	GWP A1-C4 (kgCO <sub>2</sub> e/kg)	Pallet product code
75	0.034	2.20	1200	600	4	64	2.800	7.98	9.16	1.33	1.53	673084
50	0.034	1.45	1200	600	6	96	4.320	5.32	6.11	1.33	1.53	673083

All dimensions are nominal

EPD ID: S-P-04004

The declared unit is 1m<sup>2</sup> of faced Rock Mineral Wool Rocksilk® Soffit Linerboard Standard, Rocksilk® Soffit Linerboard Standard (unfaced), Rocksilk® Soffit Linerboard Extra Donor Slab (for a thickness of 75mm and a declared lambda of 0.034 W/mK).

# Rocksilk® Soffit Linerboards

## Performance

THERMAL (W/mK)



FIRE CLASSIFICATION

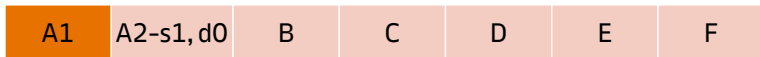

Euroclass reaction to fire classification

VAPOUR RESISTIVITY

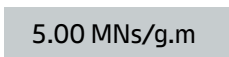

VAPOUR RESISTIVITY - FIBRE CEMENT FLAT SHEET

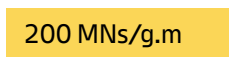

## Certification, accreditations and industry standards



## Applications

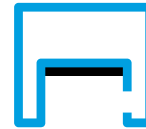

Structural soffit floors

## Typical Build-Ups



# Rocksilk® Soffit Linerboards

## Application

Rocksilk® Soffit Linerboards are used for the thermal and acoustic insulation of soffits in a wide range of both residential and non-residential buildings. Rocksilk® Soffit Linerboards are non-combustible with the best possible Euroclass A1 reaction to fire classification. Rocksilk® Soffit Linerboards are available in various facing materials. Rocksilk® Soffit Linerboard Standard is suitable for use as an insulated underlining solution in structural soffits such as underground car parks, while Rocksilk® Soffit Linerboard Extra is suitable for use as an insulated underlining solution in semi-exposed structural soffits such as open-sided car parks. Rocksilk® Soffit Linerboard Standard, or Extra, can be used in conjunction with Rocksilk® Soffit Linerboard Standard Unfaced to form a dual-layered solution for insulation thicknesses up to 300mm.

## Aesthetics

Rocksilk® Soffit Linerboards are available:

- > With a black tissue facing
- > With a fibre cement flat sheet (6mm)
- > Unfaced for use as a base layer

Alternate facings are available as a bespoke product upon request and subject to a minimum order quantity.

Rocksilk® Soffit Linerboards are available with optional fixings which match the colour of Rocksilk® Soffit Linerboard Standard and Extra.

## Standards and certification

The rock mineral wool element of Rocksilk® Soffit Linerboards has a product declaration made in conformity with the requirements of BS EN 13162:2012+A1:2015 and are manufactured in accordance with ISO 50001:2018 Energy Management Systems, ISO 14001:2015+A1:2024 Environmental Management Systems, ISO 45001:2023+A1 Occupational Health and Safety Management Systems, and ISO 9001:2015+A1:2024 Quality Management Systems.

All of our mineral wool products are made of non-classified fibres and are certified by EUCEB. EUCEB, (European Certification Board of Mineral Wool Products - [www.euceb.org](http://www.euceb.org)) is a voluntary initiative by the mineral wool industry. It is an independent certification authority that guarantees that products are made of fibres, which comply with the exoneration criteria for carcinogenicity (Note Q) of the Regulation (EC) 1272/2008.

## Thermal Modelling

The U-value of a proprietary built element (rainscreen façade/masonry cavity wall/garage soffit etc.) or system is dependent on the material properties and the degree of thermal bridging in the system. Calculations should be created using 2D or 3D modelling programs which comply with the methodologies detailed in BS EN ISO 6946:2017 or BS EN ISO 10211:2017 and using guidance from BR443:2019.

We offer simplified calculations to BS EN ISO 6946:2017 and where required numerically modelled U-value calculations using software that is compliant with BS EN ISO 10211:2017.

## System Testing

Knauf Insulation maintains declared product characteristics and qualities which are defined in detail in its Declaration of Performances (DoPs) and product literature. The product literature also includes information relating to Knauf Insulation's requirements and recommendations for installation of its products when being used as part of a system.

Any party using, or planning to use, our products in a system (with or without system testing) where performance may be dependent on product characteristics not declared on our DoPs or our product literature, must contact our Technical Service Team.

Knauf Insulation will not accept liability for any failure in system performance due to product characteristics not declared on DoPs or product literature, or not agreed in a Service Level Agreement. In such an event, any warranty given in relation to those products will be invalidated.

## Real Performance

Glass and rock mineral wool are easier to install correctly than other insulants, such as rigid boards, because they adapt to any slight imperfections in the substrate and knit together, eliminating any air gaps. Mineral wool is engineered to adapt to any imperfections, and any settlement/movement over time, so it maintains close contact and preserves thermal performance for the life of the building.

Evidence shows the absence of air gaps is crucial to achieving real performance in the relevant application. Any insulation material that doesn't deliver 'as-built' thermal performance is failing in its primary purpose, and therefore presents an unnecessary risk as the construction industry seeks to close the performance gap.

## Durability and Fitness for Use

Rocksilk® Soffit Linerboards are odourless, rot proof, non-hygroscopic, do not sustain vermin and will not encourage the growth of fungi, mould or bacteria. The products will have a life equivalent to that of the structure in which they are incorporated.

# Rocksilk® Soffit Linerboards

## Sustainability

Rocksilk® Soffit Linerboards are manufactured with ECOSE® Technology, our unique plant-based binder. It is low-carbon and generates low-VOCs, so it can be used to create better buildings - for occupiers, for installers and for the planet. ECOSE® provides the proven sustainability performance the industry needs, backed up by extensive testing and certification. ECOSE® is just one small element of our product proposition, but it makes a big difference.

Our rock mineral wool is manufactured using around 35% recycled content (recycled material mostly from the steel industry along with customer production waste).

Rocksilk® Soffit Linerboards contain no ozone-depleting substances or greenhouse gases. The overall environmental performance of our products is reported in their EPDs (Environmental Product Declarations) which are available on our website. EPDs are available for all our products in accordance with ISO 14025:2023, ISO 21930:2017 and EN 15804+A2:2019.

We have received the BES6001(v4.0) 'Very Good' rating for all our mineral wool in our three plants, which proves that our products are made with constituent materials that are responsibly sourced.

Our individual products and the pallets they sit on are wrapped in low-density polyethylene (LDPE4) plastic, which is made of 30-50% (depending on the supplier) recycled plastic content and is fully recyclable.

## Handling and Storage

Rocksilk® Soffit Linerboards should be stored properly and handled in such a way as to ensure that the product remains clean and undamaged.

The polyethylene packs / shrink-wrapped pallets used for the supply of Rocksilk® Soffit Linerboards are designed for short-term protection only. For longer term protection on site, the product should either be stored indoors or under cover and off the ground. Rocksilk® Soffit Linerboards should not be left permanently exposed to the elements.

If the main hood is removed or damaged, the remaining packs should be kept under cover indoors or protected from the elements by a weatherproof cover. In coastal locations where weather is more extreme and bird damage is more common, use additional covering or store indoors.

The product must be protected from prolonged exposure to sunlight, and stored dry and flat.

Rocksilk® Soffit Linerboards are light and easy to handle; care should be exercised to avoid crushing its edges or corners. If damaged, the product should be discarded. Damaged, contaminated or wet products must not be used.

During construction exposed areas of slabs should always be covered at the end of a day's work or in heavy rain. Polyethylene covers should be used to provide protection and prevent work from becoming saturated.

## Knauf Insulation Ltd

Stafford Road, St. Helens, Merseyside, WA10 3LZ Customer Service: 01744 766 766

All rights reserved, including those of photomechanical reproduction and storage in electronic media. Extreme caution was observed when putting together and processing the information, text and illustrations in this document. Nevertheless, errors cannot be completely ruled out. The publisher and editors cannot assume legal responsibility or any liability for incorrect information and consequences thereof. The publisher and editors will be grateful for improvement suggestions and details of possible errors pointed out. For the most up-to-date document versions and product information, please always refer to our website.